



AASHTO

COMMITTEE ON BRIDGES AND STRUCTURES
2019 MONTGOMERY, ALABAMA

June 24-27, 2019

Hosted by

AASHTO





June 23, 2019

On behalf of the Alabama Department of Transportation, welcome to Montgomery for the 2019 Annual Meeting of the AASHTO Committee on Bridges and Structures. It is a pleasure to have you here in the Yellowhammer State where we are celebrating 200 years of statehood. We hope that you will enjoy your stay here!

The agenda items and other program content will cover topics impacting public and private interests nationally and internationally as well. The work you do here will continue to improve and enhance the specifications and guidelines to produce bridge and transportation structure designs that are efficient, economical and safe.

Located in central Alabama at the intersection of Interstate 65 and Interstate 85, Montgomery is rich in Southern tradition, hospitality, and vast economic diversity, yet it's a modern city on the forefront of innovation. It's the state capital and second largest city in Alabama and birthplace of two world-changing events: the Civil War and the Civil Rights Movement. Montgomery is home to Maxwell Air Force Base and the Air University—the intellectual and leadership center of the Air Force, the region's first high-speed internet exchange, and an extensive industrial base that includes Hyundai Motor Manufacturing Alabama—Hyundai's first manufacturing plant in the United States. It's got almost two centuries of tales to tell, and it's jam-packed with culture, entertainment, and activity options for all interests. Take time to tour Montgomery and see its many faces for yourself by enjoying our attractions, exploring our history, and meeting our friendly people.

We look forward to a productive and beneficial meeting and hope that you visit Alabama again soon.

Sincerely,

Tim Colquett, P.E.

State Bridge Engineer

Table of Contents

Annual Meeting Hosts	Page 4
Hotel Floor Plan	Page 5
General Information	Page 7
Schedule of Events and Locations	Page 9
Technical Committee Meeting Agendas	Page 11
T-1 AASHTO Technical Committee for Bridge Security and Hazards	Page 11
T-2 AASHTO Technical Committee for Bearings and Expansion Devices	Page 11
T-3 AASHTO Technical Committee on Seismic Design	Page 13
T-4 AASHTO Technical Committee for Construction	Page 15
T-5 AASHTO Technical Committee on Loads and Load Distribution	Page 16
T-6 AASHTO Technical Committee on Fiber Reinforced Polymer Composites	Page 17
T-7 AASHTO Technical Committee on Guardrail and Bridge Rail	Page 19
T-8 AASHTO Technical Committee for Movable Bridges	Page 19
T-9 AASHTO Technical Committee on Bridge Preservation	Page 21
T-10 AASHTO Technical Committee for Concrete Design	Page 21
T-11 AASHTO Technical Committee for Research	Page 22
T-12 AASHTO Technical Committee on Structural Supports for Signs, Luminaires, and Traffic Signals	Page 23
T-13 AASHTO Technical Committee for Culverts	Page 23
T-14 AASHTO Technical Committee for Structural Steel Design	Page 24
T-15 AASHTO Technical Committee for Substructures and Retaining Walls	Page 25
T-16 AASHTO Technical Committee for Timber Structures	Page 26
T-17 AASHTO Technical Committee for Metals Fabrication	Page 26
T-18 AASHTO Technical Committee for Bridge Management, Evaluation, and Rehabilitation	Page 27
T-19 AASHTO Technical Committee for Software and Technology	Page 28
T-20 AASHTO Technical Committee for Tunnels	Page 29
General Session Proceedings	Page 31
AASHTO Committee on Bridges and Structures (CBS): Members	Page 37
AASHTO Committee on Bridges and Structures (CBS): Associate Members	Page 44
AASHTO Committee on Bridges and Structures (CBS): FHWA	Page 45
AASHTO Regional Map	Page 39
Technical Committee Rosters	Page 47
Thank You to Our Sponsors!	Page 53
Professional Development Hours Form	Page 55



Annual Meeting Hosts

1998 ... Nashville, Tennessee
1999 ... San Diego, California
2000 ... Charleston, South Carolina
2001 ... Seattle, Washington
2002 ... Atlantic City, New Jersey
2003 ... Albuquerque, New Mexico
2004 ... Orlando, Florida
2005 ... Newport, Rhode Island
2006 ... Snowbird, Utah
2007 ... Wilmington, Delaware
2008 ... Omaha, Nebraska
2009 ... New Orleans, Louisiana
2010 ... Sacramento, California

2011 ... Norfolk, Virginia
2012 ... Austin, Texas
2013 ... Portland, Oregon
2014 ... Columbus, Ohio
2015 ... Saratoga Springs, New York
2016 ... Minneapolis, Minnesota
2017 ... Spokane, Washington
2018 ... Burlington, Vermont

2019 ... *Montgomery, Alabama*

2020 ... Branson, Missouri
2021 ... Indiana
2022 ... Pennsylvania



AASHTO

Fully Modernized Bridge Design & Rating (6.8.4/7.0)

Coming Summer 2019!

- Fully modernized, user friendly interface, increased engine performance, significantly decreased analysis time
- Design superstructures and substructures in accordance with the AASHTO LRFD Bridge Design Specifications.
- Rate bridge superstructures in accordance with the AASHTO Manual for Bridge Evaluation, AASHTO Standard Specifications for Highway Bridges, and AASHTO LRFD Bridge Design Specifications.
- Enter data once for design and rating (One stop shop)
- Design and rate superstructures types that represent 95% of the current US bridge inventory (steel girders, prestressed concrete, concrete multi-cell box girders (RC and PT), RC beams and slabs, concrete culverts and frames, trusses, etc.)

Check the AASHTOWare Store, , <https://store.aashtoware.org/> for availability in the summer.

Hotel Floor Plan

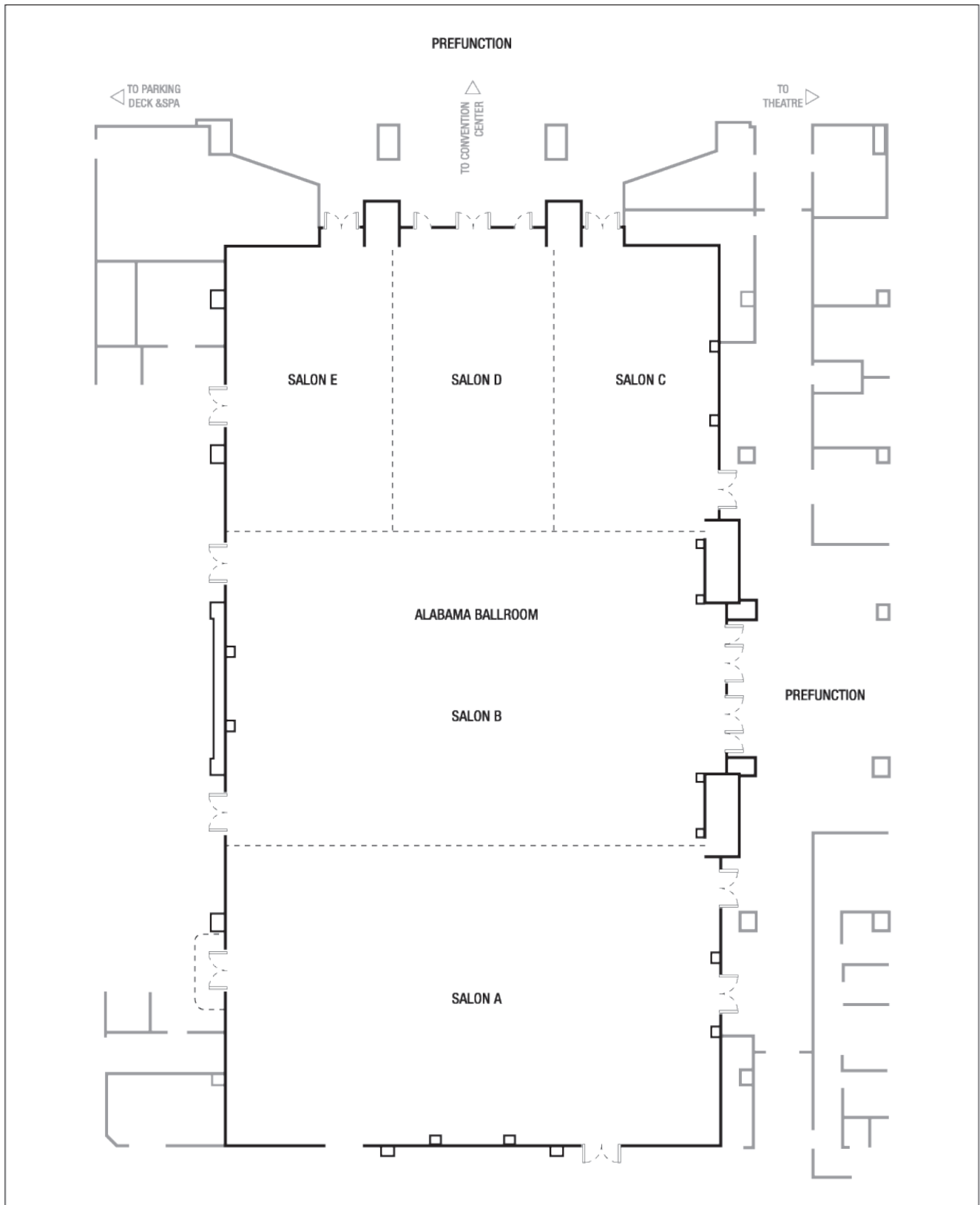

ENDLESS POSSIBILITIES



It's not just steel that supports these bridges

Acrow bridge and lift span accommodates both road and water traffic during construction in The Palm Beaches, Florida.

With nearly 70 years of experience in bridge engineering, manufacturing, supply and project management, Acrow's prefabricated modular steel bridge technology is designed to meet a variety of permanent, detour and emergency infrastructure needs.

ACROW
B R I D G E

 Made in the USA

www.acrow.com

sales@acrow.com

+1.973.244.0080

General Information



Registration/Information Hours

The registration/information desk is located on the 1st floor and is available on the days and times listed below. Lost and found will be located at the registration/information desk.

- **Sunday: 12:00 p.m.–6:00 p.m.**
- **Monday: 7:00 a.m.–5:00 p.m.**
- **Tuesday: 7:00 a.m.–5:00 p.m.**
- **Wednesday: 7:00 a.m.– 5:00 p.m.**
- **Thursday: 7:00 a.m.–5:00 p.m.**



Name Badge and Meeting/Event Admission

All registered attendees and guests are required to wear their name badge to gain entry into all meetings and events, including meals, breaks, registered guest activities, the ice breaker, and the host night event. Badges will be scanned at all sessions as well as traditional sign in sheets.



Breaks and Meals

All meals are provided for attendees and registered guests as indicated in the schedule of events. Attendees and their guests must be registered to attend the breakfasts, breaks, and lunches. Morning and afternoon breaks will be held in the Alabama Ballroom Foyer on the 1st floor. Breakfast and lunch will be held in the Exhibit Hall B.



Cell Phones

Please silence or turn off all electronics during the meetings and events, as a courtesy to others.



Wi-Fi

Network Name: Renaissance_Conference

Password: BRIDGES (not case sensitive)

INSTRUCTIONS:

1. Open a web browser
2. Enter the passcode
3. Accept the terms & conditions & click "ok"



Dress Code

The dress code for all meetings is business casual. The dress code for all guest programs is casual. Wear your best hawaiian shirt, your favorite shorts, and your flip flops on Sunday evening to the Alabama Shrimp Boil. You can also come as casual as you would like for the host night event Wednesday evening.



Meeting Staff

ALDOT volunteer staff will be available to assist you with any questions you may have. ALDOT staff will be wearing navy polo shirts for easy identification.



Professional Development Hours

Professional Development Hours will be based on attendance at the technical and general sessions. A list of the hours available is on page 53 of the program guide. This form will serve as a record for all hours completed at this meeting. AASHTO will not provide certificates to attendees after the conference.



Photographs

In addition to the group photo, photographs will be taken at various meetings. These photos may be used on the AASHTO website or in future presentations. If you have concerns about the photos, please let Kristen Thomas know prior to the meeting.



Meeting Mobile App

Browse the meeting agenda on your phone or tablet via the event mobile app. Along with navigating the event agenda, you can use the app to communicate with other attendees, build a personalized meeting schedule, keep up to date on agenda changes, take notes during your meeting, and last, but certainly not least, track your Professional Development Hours. For those without a smart phone or who would like to access the information in a web browser, visit <https://crowd.cc/bridges> and for downloading the app on your mobile phone please follow the instructions:

1. Download "CrowdCompass AttendeeHub" mobile app or visit: <https://crowd.cc/s/2ZCQ4>
2. Once the App is Downloaded and opened up already, type "AASHTO 2019 Committee on Bridges" in the search box.
3. Download the event
4. Once the event is downloaded, you will be prompted to Log In
5. Enter Information as requested and a 4-digit Verification Code would be sent to your email inbox/ mobile number
6. Access the code and input within the mobile app
7. You'll be logged in successfully with a welcome message.



Guest/Spouse Programs

Gather at the registration/information desk for guest/spouse tours each day. The following daily agenda has been created by ALDOT to showcase some of Alabama's finest locations:

Monday: Trip to Selma, Montgomery Historic Cultural Tour

After departing the hotel at 9:30 am, the group will visit the Lowndes County Interpretive Center, enjoy lunch at a local Selma restaurant, take a guided tour of the Chapel A.M.E. Church, and visit the Pettus Bridge Walk and Memorial Park. Return time will be 3:45 pm. Cost is \$22/person for the day, not including lunch.

Tuesday: Montgomery Capitol and Cultural Tour

Tuesday's tour departs at 8:30, and will visit the State Capitol, Blount Cultural Park, and the Montgomery Museum of Fine Arts. After lunch at the museum café, the group will visit the Hank Williams Grave Site and Museum. Return time will be 3:00 pm. Cost is \$10/person for the day, not including lunch.

Note: Participation in the above activities does not require registration however access to hotel food functions (daily breakfast and lunches), Opening Reception (Sunday) and Host State Night Event (Wednesday) does require guest/spouse registration.



Bridge Preservation



Bridge Design



Accelerated Bridge Construction /
CMAR Services

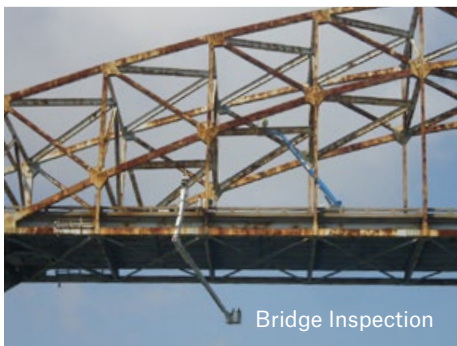

Bridge Inspection



Underwater Bridge Inspection

From interstates and intersections to bridges and bike paths, transportation systems connect us to the people and places we care about most – and this idea drives the work we do at Gresham Smith.

Our designs are grounded in safety and efficiency, pushing boundaries toward multi-modal, technology-driven solutions. Finding better ways of moving people and products requires specialized knowledge of policies, thoughtful planning and complex technical work. That's how we live out our genuine desire to boost the quality of life within the context of each unique community.

Schedule of Events and Locations

Sunday, June 23, 2019

Noon.–5:00 p.m.	Registration	Alabama Ballroom Pre-Function
6:00 p.m.–9:00 p.m.	Welcome Reception	Union Station Train Shed

Monday, June 24, 2019

7:00 a.m.–5:00 p.m.	Registration	Alabama Ballroom Pre-Function
7:00 a.m.–8:30 a.m.	Breakfast	Exhibit Hall B
8:00 a.m.–Noon	Technical Committee Meetings: T-2: Bearings & Expansion Devices T-5: Loads & Load Distribution T-8: Movable Bridges T-9: Bridge Preservation T-16: Timber Structures	Alabama C Alabama B Alabama D Alabama A Alabama E
9:45 a.m.–10:15 a.m.	Break	Alabama Ballroom Pre-Function
Noon–1:00 p.m.	Lunch	Exhibit Hall B
1:00 p.m.–5:00 p.m.	Technical Committee Meetings: T-1: Bridge Security and Hazards T-3: Seismic Design T-10: Concrete Design T-12: Structural Supports T-19: Software and Technology	Alabama D Alabama E Alabama A Alabama C Alabama B
2:45 p.m.–3:15 p.m.	Break	Alabama Ballroom Pre-Function

Tuesday, June 25, 2019

7:00 a.m.–5:00 p.m.	Registration	Alabama Ballroom Pre-Function
7:00 a.m.–8:00 a.m.	Breakfast	Exhibit Hall B
8:00 a.m.–Noon	Technical Committee Meetings: T-6: Fiber Reinforced Polymer Composites T-13: Culverts T-15: Substructures & Retaining Walls T-17: Metals Fabrication T-18: Bridge Management, Evaluation, & Rehabilitation	Alabama E Alabama D Alabama B Alabama C Alabama A



9:45 a.m.–10:15 a.m.	Break	<i>Alabama Ballroom Pre-Function</i>
Noon–1:00 p.m.	Awards Lunch	<i>Exhibit Hall B</i>
1:00 p.m.–5:00 p.m.	Technical Committee Meetings: T-4: Construction T-7: Guardrail & Bridge Rail T-11: Research T-14: Structural Steel Design T-20: Tunnels	<i>Alabama B</i> <i>Alabama E</i> <i>Alabama D</i> <i>Alabama A</i> <i>Alabama C</i>
2:45 p.m.–3:15 p.m.	Break	<i>Alabama Ballroom Pre-Function</i>

Wednesday, June 26, 2019

7:00 a.m.–5:00 p.m.	Registration	<i>Alabama Pre-Function</i>
7:00 a.m.–8:00 a.m.	Breakfast	<i>Exhibit Hall B</i>
8:00 a.m.–Noon	State Bridge Engineers Meeting (Closed)	<i>Alabama AB</i>
9:45 a.m.–10:15 a.m.	Break	<i>Alabama Ballroom Pre-Function</i>
Noon–1:00 p.m.	Lunch	<i>Alabama Pre-Function</i>
1:00 p.m.–5:00 p.m.	General Session	<i>Alabama AB</i>
2:45 p.m.–3:15 p.m.	Break	<i>Alabama Ballroom Pre-Function</i>
6:00 p.m.	Host State Night	<i>At Alley Station</i>

Thursday, June 27, 2019

7:00 a.m.–5:00 p.m.	Registration	<i>Alabama Pre-Function</i>
7:00 a.m.–8:00 a.m.	Breakfast	<i>Exhibit Hall B</i>
8:00 a.m.–Noon	General Session	<i>Alabama AB</i>
9:45 a.m.–10:15 a.m.	Break	<i>Alabama Pre-Function</i>
Noon–1:00 p.m.	Lunch	<i>Exhibit Hall B</i>
1:00 p.m.–4:00 p.m.	General Session	<i>Alabama AB</i>
2:30 p.m.–3:00 p.m.	Break	<i>Alabama Pre-Function</i>
4:30 p.m.–7:00 p.m.	Executive Committee Meeting (by invitation only)	<i>Montgomery 7</i>

AASHTO Technical Committee Meetings

T-1 <i>Alabama D</i>	AASHTO Technical Committee for Bridge Security and Hazards Cheryl Hersh Simmons, Utah DOT, Chair Monday, June 24, 2019 1:00 p.m.–5:00 p.m.
--------------------------------	--

1:00 p.m.	Welcome and Introductions	Cheryl Hersh Simmons <i>Chair</i>
1:15 p.m.	FHWA Security Research Update and Recent Advances in Bridge Security Research	Sheila Duwadi <i>FHWA Turner Fairbank Senior Research Engineer, Safety & Security</i> Vincent Chiarito <i>FHWA Research Senior Bridge Engineer, Safety & Security</i>
1:45 p.m.	State of Practice: Bridge Security Overview	Carrie Davis, P.E. <i>Structural Consultants</i>
2:05 p.m.	ASCE SEI Structural Design for Physical Security: New Bridge Design Chapter	Rob Smith, S.E., P.E., SEng, FICE, MStructE, PEng <i>ARUP</i>
2:25 p.m.	TSA Update	David Cooper <i>U.S. Department of Homeland Security/TSA</i>
2:45 p.m.	Break	
3:15 p.m.	Business Session	T-1 Members Only
5:00 p.m.	Adjourn	

T-2 <i>Alabama C</i>	AASHTO Technical Committee for Bearings and Expansion Devices Carl Puzey, Illinois DOT, Chair Monday, June 24, 2019 8:00 a.m.–Noon
--------------------------------	--

8:00 a.m.	Welcome and Introductions	Carl Puzey <i>Chair</i>
8:10 a.m.	Non-Destructive Testing of HLMR Bearings	Ron Watson <i>RJ Watson, Inc.</i>
8:40 a.m.	A19 Test Protocol—Lessons Learned, Industry Reconciliation, Owner Protocol, and Enforcement	Steve Pabst <i>Watson Bowman</i> Tom Lewis <i>DS Brown Co.</i>

(T-2 Agenda cont'd)



DESIGNED TO AMAZE,
ENGINEERED TO LAST



Hardesty & Hanover proudly supports the work of the
AASHTO Committee on Bridges and Structures.

www.hardestyhanover.com

1501 BROADWAY, NEW YORK, NY 10036 • T: 212.944.1150 • F: 212.391.0297
INFO@HARDESTYHANOVER.COM • TWITTER: @HARDESTYHANOVER

What if?

At Jacobs, we think differently about the future.
We deliver outstanding bridge projects of all types
and sizes — steel or concrete, fixed or movable,
highway or railway.

**We start with “what if” to surface new possibilities and
harness technical innovation and expertise to bring
complex and challenging bridge design and construction
solutions to fruition.**



#WhatIf
jacobs.com/whatif

Follow us @JacobsConnects

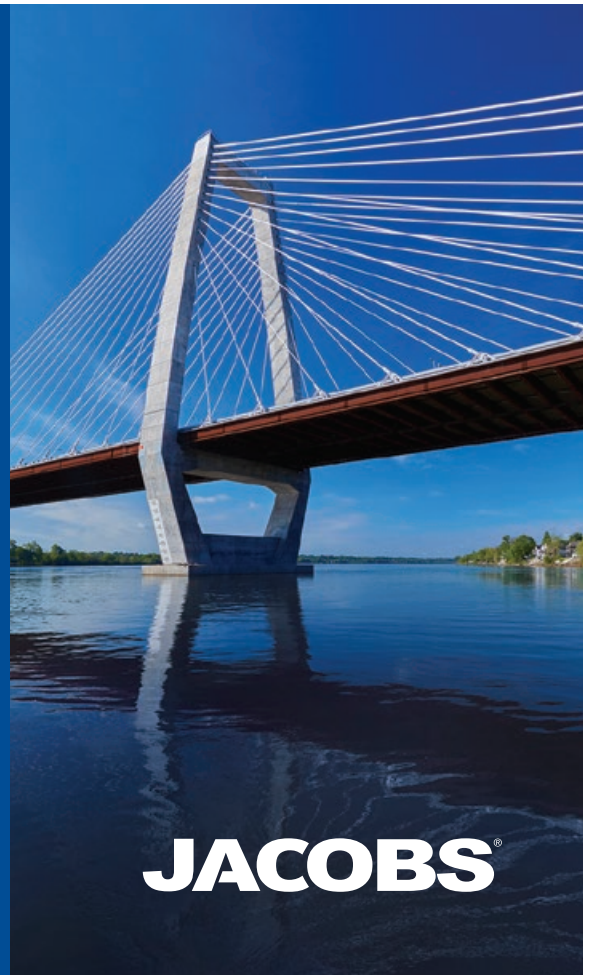

JACOBS®

(T-2 Agenda cont'd)

9:10 a.m.	Update on Disc-Bearing Specification Review and Potential Revisions	Sougata Roy <i>Sougata Roy, LLC</i>
9:45 a.m.	Break	
10:15 a.m.	T-2 Committee Discussion Items: <ul style="list-style-type: none"> • Potential disc bearing revisions • PTFE adhesive & bond testing issues • AASHTO M251 8.9.2 conditioning times • Other potential ballots items for 2020 <ul style="list-style-type: none"> ▪ A19 5.3.1.2 & 5.3.1.3 inconsistency ▪ C14.7.6.1 width vs length ▪ A19 5.3.4.1.1 specimen length change 	T-2 Committee
11:15 p.m.	T-2 Work Plan	T-2 Committee
11:30 p.m.	T-2 Research Priorities	T-2 Committee
Noon	Adjourn	

T-3 <i>Alabama E</i>	AASHTO Technical Committee on Seismic Design Rich Pratt, Alaska DOT&PF, Chair Monday, June 24, 2019 1:00 p.m.–5:00 p.m.
--------------------------------	---

1:00 p.m.	Welcome and Introductions	Richard Pratt <i>Chair</i>
1:10 p.m.	Why Structural Engineers Need to Be Involved in Seismic Hazard Representation: The Impact of Response Spectra Definitions on the Seismic Design of Bridges	Ariadne Palma <i>Graduate Research Assistant, North Carolina State University</i>
2:10 p.m.	Unresolved Issues in Damping and Their Impact on Bridge Displacement Estimation	Mervyn Kowalsky, Ph.D., P.E. <i>North Carolina State University</i>
2:55 p.m.	Break	
3:15 p.m.	Research in Support of Seismic Bridge Design and Detailing in Alabama	Justin Marshall, Ph.D., P.E. <i>Auburn University</i>
3:45 p.m.	Research Updates: <ul style="list-style-type: none"> • Performance Based Seismic Design (NCHRP 12-106) including AASHTO Hazard Map Update • Update on AASHTO Seismic Specifications for ABC Column Connections (NCHRP 12-105) • Tsunami Guide Specifications 	Thomas Murphy, Ph.D., P.E., S.E. <i>Modjeski and Masters</i>

(T-3 Agenda cont'd)



Imagine it. Delivered.

AECOM's transportation experts
are meeting today's demands
and laying the foundation for
tomorrow's needs.

aecom.com

AECOM



Bridging the gap between
idea + achievement

hdrinc.com



Courtesy of AIDOT

Proud silver sponsor of the annual AASHTO Committee
on Bridges and Structures working meeting.



Connecting
our communities

Design with community in mind
stantec.com/bridges



(T-3 Agenda cont'd)

4:30 p.m.	T-3 Research Priorities and Planning	Committee
5:00 p.m.	Adjourn	

T-4 <i>Alabama B</i>	AASHTO Technical Committee for Construction Carmen Swanwick, Utah DOT, Chair Tuesday, June 25, 2019 1:00 p.m.–5:00 p.m.	
--------------------------------	---	--

1:00 p.m.	Welcome and Introductions	Carmen Swanwick <i>Chair</i>
1:10 p.m.	Old Business: <ul style="list-style-type: none"> Approval of December 2018 Mid-Year Meeting Minutes Other old business 	Ahmad Abu-Hawash <i>Vice Chair</i>
1:15 p.m.	Ballot Items: <ul style="list-style-type: none"> T-4: GDSTBW Article 2.3.5.2 (Wind Load Revisions) T-4: FIO Proposed AASHTO GDCTB T-13: LRFD BCS Article 27.6.1 T-15: LRFD BCS Section 7 Earth Retaining Structures—Additions T-15: LRFD BCS Section # Soil Nails—New Section Others 	Carmen Swanwick <i>Chair</i> T-13 Matt Chynoweth
1:45 p.m.	Research Update and Needs: <ul style="list-style-type: none"> Report by Research Projects and Needs Coordinator (Discuss All Projects—Spreadsheet) RNS Development of Timelines/Incentives/Disincentives for ABC Project NCHRP 20-07/Task 388 Guidelines for Design and Construction of Temporary Bridges—Update Proposed RNS NCHRP 20-05 Bridge Construction Inspection Training Synthesis Proposed RNS NCHRP 20-0X Best Practices for Bridge Detailing for Durability NCHRP 20-05 Topic 49-03; Bridge Demolition Practices—To be published by June 2019 NCHRP 20-44(04) Implementing Products from Research on Adhesive Anchor Systems 	Ahmad Abu-Hawash Ahmad Abu-Hawash Carmen Swanwick Kathy Crowell Kathy Crowell Carmen Swanwick Ahmad Abu-Hawash William Nickas
2:30 p.m.	Discussion Topics: <ul style="list-style-type: none"> AASHTO LRFD Bridge Specifications Update—Scope of Work AASHTO Guide Specifications for ABC—Training Development ABC Traffic Impact Tier Levels; Terms for Contracting (ABC—UTC Database) FHWA—Quality Assurance Document (WSP) 	Mark Gaines Carmen Swanwick/ Mike Culmo Ahmad Abu-Hawash Carmen Swanwick

(T-4 Agenda cont'd)



(T-4 Agenda cont'd)

2:45 P.m.	Break	
3:15 p.m.	Presentations <ul style="list-style-type: none"> FHWA Update TRB ABC Joint Subcommittee Update ABC-UTC Update PCI Update NSBA Update ASBI Update Updates from Other Committees Updates to Strategic Plan/Task Other discussion 	Romeo Garcia (FHWA) (10 min) Ahmad Abu-Hawash (10 min) Atorod Azizinamini, FIU (15 min) William Nickas, PCI (15 min) Jeff Carlson, NSBA (15 min) Gregg Freeby, ASBI (15 min) T-4 Liaisons (10 min) Committee Committee
4:55 p.m.	Other Business <ul style="list-style-type: none"> 2019 T-4 Mid-Year Meeting—December (ABC–UTC; ABC Conference) 	Carmen Swanwick <i>Chair</i>
5:00 p.m.	Adjourn	

T-5 <i>Alabama B</i>	AASHTO Technical Committee on Loads and Load Distribution Jeffrey Robert, Maryland DOT, Chair Monday, June 24, 2019 8:00 a.m.–Noon
--------------------------------	--

8:00 a.m.	Welcome and Introductions	Jeffrey Robert <i>Chair</i>
8:05 a.m.	Approval of Past Meeting Minutes	Lubin Gao <i>FHWA Ex-Officio</i>
8:10 a.m.	Ballot Item—Articles 3.6.5 and C3.6.5 Vehicular Collision Force (CT)	Arielle Ehrlich <i>Minnesota DOT</i> Jeffrey Robert <i>Maryland DOT</i>
8:50 a.m.	T-13 Ballot Items—Article 3.6.1.2.6a	Josh Beakley <i>ACPA</i>
9:10 p.m.	Ballot Items—Update of Other Technical Committee’s Work	Jeffrey Robert <i>Maryland DOT</i>

(T-5 Agenda cont'd)

(T-5 Agenda cont'd)

9:20 a.m.	Update on Truck Platooning Study	Wagdy Wassef, Ph.D., P.E. WSP
9:45 a.m.	Break	
10:15 a.m.	Live Load Distribution and Dynamic Amplification on a Curved Prestressed Concrete Transit Bridge	John Lobo P.E., M.ASCE HDR, Inc. Easa Khan, Ph.D. Wood
11:05 a.m.	Update on Tsunami Guide Specification	Tom Murphy, Ph.D., P.E. Modjeski & Masters, Inc.
11:50 a.m.	General Discussion	Committee
Noon p.m.	Adjourn	

T-6 <i>Alabama E</i>	AASHTO Technical Committee on Fiber Reinforced Polymer Composites Matthew Chynoweth, Michigan DOT, Chair Tuesday, June 25, 2019 8:00 a.m.–Noon
--------------------------------	---

8:00 a.m.	Welcome and Introductions	Matthew Chynoweth Chair
8:15–8:45 a.m.	Development and Delivery of Training Materials for FRP Design and Construction for State DOTs	J. Elkaissi
8:45–9:15 a.m.	UMaine/AIT Composite Girder System	M. Frankhauser
9:15–9:45 a.m.	NCHRP 20-07 Task 428, in Updating the <i>Guide Specifications for Design of Bonded FRP Systems for Repair</i>	Matthew Chynoweth
9:45–10:05 a.m.	Break	
10:05–10:35 a.m.	Halls River Bridge Project	W. Potter
10:35–11:05 a.m.	Hampton Roads Bridge Tunnel Approaches FRP Repairs	A. Zickler
11:05–11:35 a.m.	Oregon Deck Overhang Strengthening with NSM CFRP	T. Potisuk
11:35–Noon	<ul style="list-style-type: none"> T-6 Strategic Plan Discussion Pooled-Fund Study: Durability Evaluation of In-Service FRP Composites in Highway Structures FDOT FRP Website 	Committee
Noon	Adjourn	

UNSURPASSED TECHNICAL EXCELLENCE IN LONG-SPAN STRUCTURES

HNTB

HNTB is a proud supporter of AASHTO and the Committee on Bridges and Structures. Since its founding more than 100 years ago, HNTB has long been recognized as an industry leader in planning, design and construction of complex long-span and movable bridges.



Franklin Avenue Bridge, Minneapolis



John Greenleaf Whittier Memorial Bridge, Newburyport and Amesbury, Massachusetts

The HNTB Companies
Infrastructure Solutions



hntb.com



DAUPHIN ISLAND BRIDGE ► ALABAMA



VETERANS MEMORIAL BRIDGE ► FLORIDA

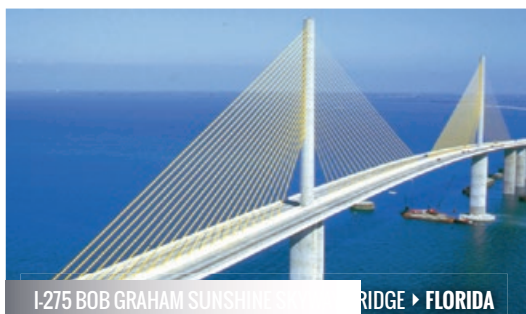

I-275 BOB GRAHAM SUNSHINE SKYWAY BRIDGE ► FLORIDA



**40
YEARS**

**404
AWARDS**

FOR OUR CUSTOMERS
ACROSS THE UNITED STATES



CREATING BRIDGES AS ART®
www.figgbridge.com | 1 800 358 3444

FIGG was EOR and CEI or
On-site Technical Support on these bridges



I-230 GLASS CITY SKYWAY ► OHIO



BRATTLEBORO BRIDGE ► VERMONT



I-35W BRIDGE ► MINNESOTA



T-7 <i>Alabama E</i>	<i>AASHTO Technical Committee on Guardrail and Bridge Rail</i> Tim Keller, Ohio DOT, Chair Tuesday, June 25, 2019 1:00 p.m.–5:00 p.m.
--------------------------------	---

1:00 p.m.	Welcome and Introductions	Tim Keller <i>Chair</i>
1:05 p.m.	Midwest Pooled-Fund Update	Ronald Faller, Ph.D. <i>MwRSF</i>
2:05 p.m.	TTI Pooled-Fund Update	William Williams <i>TTI</i>
3:05 p.m.	Break	
3:20 p.m.	Texas DOT Bridge Rails	Jamie Farris <i>TxDOT</i>
4:20 p.m.	Research Discussion <ul style="list-style-type: none"> • NCHRP 22-35 • NCHRP 22-36 • NCHRP 22-41 • Other 	Tim Keller <i>Chair, Ohio DOT</i>
4:45 p.m.	Open Discussion	Tim Keller <i>Chair, Ohio DOT</i>
5:00 p.m.	Adjourn	

T-8 <i>Alabama D</i>	<i>AASHTO Technical Committee for Movable Bridges</i> Zhengzheng (Jenny) Fu, LaDOTD, Chair Monday, June 24, 2019 8:00 a.m.–Noon
--------------------------------	---

8:00 a.m.	Introduction: (T-8 members and friends of T-8)	Zhengzheng (Jenny) Fu <i>Chair</i>
8:10 a.m.	Approval of 2018 SCOBS T-8 meeting Minutes	T-8 Members
8:20 a.m.	NCHRP Project 12-112 Update—Update of the AASHTO LRFD Movable Highway Bridge Design Specifications	Jeff Newman <i>Modjeski & Masters</i>
8:40 a.m.	Broadway Bridge Rail Wheel Replacement Project	Jon Henrichsen <i>MCTD</i>

(T-8 Agenda cont'd)



(T-8 Agenda cont'd)

9:00 a.m.	92nd Street Bascule Bridge Repairs	Patrick J Marra WJE John R. Williams SBE
9:20 a.m.	Small Bridges, Big Challenges	Keith R. Griesing H&H
9:40 a.m.	U.S. vs. Europe Code Compliance	Paul Skelton H&H
10:00 a.m.	Acrow Temp. Lift Bridge on SR 80 Bridge Replacement Project, West Palm Beach, Florida	Michael J. Parciasepe ACROW
10:20 a.m.	Span Drive Machinery Vibration at Hood Canal Bridge	Ryan Kanagy SBE
10:40 a.m.	Movable Bridge Remote Operation Practices	Rob Moses & Raphael Costa HDR
	T-8 Committee Business Items:	
11:00 a.m.	Conference Call (4/12/19) Recap	
11:05 a.m.	Previous NCHRP 20-07 Task 403—Develop Detailed Elements for Movable Bridge Inspection and Management	
11:20 a.m.	20-07 Task 424—Operation of Movable Bridges from Remote Locations	
11:25 a.m.	Buy America Wavier	
11:35 a.m.	Develop T-8 Strategic Plan and Future Research Needs (will request a specialized technical support contract)	
11:45 a.m.	Mid-Year Meeting Plan	
Noon	Adjourn	



Please make sure to have your badge scanned or sign the paper sign-in sheets to record your attendance in all sessions.

T-9 <i>Alabama A</i>	<i>AASHTO Technical Committee on Bridge Preservation</i> Jim Nelson, Iowa DOT, Chair Monday, June 24, 2019 8:00 a.m.–Noon
--------------------------------	---

8:00 a.m.	Welcome and Introductions	Jim Nelson <i>Chair</i>
8:15 a.m.	Review Ballot Items	Tom Murphy <i>Modjeski & Masters</i> George Hearn <i>University of Colorado—Boulder</i> Chris Higgins <i>Oregon State University</i> Ray Bottenberg <i>Oregon DOT</i>
9:45 a.m.	Break	
10:15 a.m.	Bridge Preservation using Cathodic Protection	Paul Vinik <i>GPI</i>
10:30 a.m.	SCOM Bridge Technical WG Update	David Miller <i>Louisiana DOTD</i>
10:45 a.m.	<i>Bridge Preservation Video & ETG Update</i>	Raj Alainey <i>FHWA</i>
11:00 a.m.	FHWA Long-Term Bridge Program Update	Jean Nehme <i>FHWA</i>
11:15 a.m.	TSP2 Bridge Preservation Update	Ed Welch <i>NCPP (invited)</i>
11:30 a.m.	T-9 Research Priorities, Strategic Plan	Jim Nelson <i>Chair</i>
Noon	Adjourn	

T-10 <i>Alabama A</i>	<i>AASHTO Technical Committee for Concrete Design</i> Kevin Western, Minnesota DOT, Chair Monday, June 24, 2019 1:00 p.m.–5:00 p.m.
---------------------------------	---

1:00 p.m.	Introduction	Committee
1:15 p.m.	Review/Approve Louisville Meeting Minutes	Kevin Western <i>Chair</i>

(T-10 Agenda cont'd)



(T-10 Agenda cont'd)

1:10 p.m.–1:20 p.m.	Approve T10 Ballot items: <ul style="list-style-type: none"> • WAI 195A—Debonding • WAI 197—PT System • WAI 199—Column Ties 	Committee
2:20 p.m.	FHWA/PCI/AASHTO Products NCBC Activities	William Nickas
2:45 p.m.	Break	
3:15 p.m.	PCI UHPC Research Implementation	Maher Tadros
3:40 p.m.	FHWA UHPC Research	Ben Graybeal
4:10 p.m.	NCHRP Update	Waseem Dekelbab
4:30 p.m.	EIT Scanning Tour	Graham Bettis
4:50 p.m.	Discuss future items/Next meeting	Committee
5:00 p.m.	Adjourn	

T-11 <i>Alabama D</i>	AASHTO Technical Committee for Research Anne Rearick, Indiana DOT, Chair Tuesday, June 25, 2019 1:00 p.m.–5:00 p.m.
---------------------------------	---

1:00 p.m.	Welcome and Introductions	Anne Rearick <i>Chair</i>
1:15 p.m.	TRB Structures Section Update	Barney Martin <i>Chair, TRB Structures Section</i>
1:45 p.m.	TRB Research Update	Waseem Dekelbab <i>TRB</i>
2:15 p.m.	Presentation TBD	TBD <i>TBD</i>
2:45 p.m.	Break	
3:15 p.m.	Open Discussion	
11:00 a.m.	T-11 Business Meeting (<i>Closed to Public</i>)	T-11 Members
Noon	Adjourn	

T-12 <i>Alabama C</i>	<i>AASHTO Technical Committee on Structural Supports for Signs, Luminaires, and Traffic Signals</i> Sam Fallaha, Florida DOT, Chair Monday, June 25, 2018 1:00 p.m.–5:00 p.m.
---------------------------------	---

1:00 p.m.	Welcome and Introductions	Sam Fallaha <i>Chair</i>
1:05 p.m.	Approval of Minutes of Past Meetings	Jason Hastings
1:15 p.m.	<ul style="list-style-type: none"> WAI LRFD 09: Section 14, Article 14.4.4.8 WAI SLTS 05: Section 5, Article 5.15.5 	Committee
1:30 p.m.	WAI LRFD 14: Section 3, Article C3.7	Committee
1:45 p.m.	WAI LRFD 28: Section 6, Table 6.5.1-12	Committee
2:00 p.m.	KDOT Experience with HMLT	Karen Peterson, P.E.
2:20 p.m.	Presentation: LRFD Section 6, Aluminum Design Update	Randy Kissell, P.E. <i>Trinity Consultants</i>
3:00 p.m.	Break	
3:20 p.m.	Re-Tightening the Large Anchor Bolts of Support Structures for Signs and Luminaires	An Chen, Ph.D., P.E., LEED AP <i>Iowa State University</i>
4:00 p.m.	Plan for the 2020 Wind Maps Update	Committee
4:20 p.m.	General Discussion	Committee
5:00 p.m.	Adjourn	

T-13 <i>Alabama D</i>	<i>AASHTO Technical Committee for Culverts</i> Jason Hastings, Delaware DOT, Chair Tuesday, June 25, 2019 8:00 a.m.–Noon
---------------------------------	--

8:00 a.m.	Welcome and Introductions	Jason Hastings <i>Chair</i>
8:10 a.m.	Approval of Minutes: <ul style="list-style-type: none"> 2018 Annual Meeting (Burlington) 	Jason Hastings <i>Chair</i>

(T-13 Agenda cont'd)



(T-13 Agenda cont'd)

8:15 a.m.	2019 Ballot Items: <ul style="list-style-type: none"> • WAI 19-01 Design 3.6.1.2.6a (1) • WAI 19-02 Design 3.6.1.2.6a (2) • WAI 19-03 Design 12.5.4 • WAI 19-05 Construction C27.6.1 • WAI 19-06 Design 12.12.3.10.2b-4 • WAI 19-07 Design C12.12.3.5 • WAI 19-09 Design 12.12.3.10 • WAI 19-10 Design 12.4.2.10 • WAI 19-11 Design Chapter 12 Various (1) • WAI 19-12 Design Chapter 12 Various (2) • WAI 19-13 Culvert Guide Appendices 	Jason Hastings <i>Chair</i>
9:15 a.m.	Presentation: Seismic Design Method for Long-Span Corrugated Steel Culverts and Buried Bridges	Jesse Beaver <i>Simpson Gumpertz & Heger</i>
9:30 a.m.	Break	
10:00 a.m.	NCHRP 15-54 Rating of Buried Structures	TBD
10:20 a.m.	Introduction of 2020 Ballot Items	Various
10:50 a.m.	Calculating E-80 Railroad Live Loads on Sliplined CMP Pipe	Tim Toliver <i>Advance Pipe Services</i>
11:10 a.m.	Research: <ul style="list-style-type: none"> • TRB AFF70 Update • Research Needs 	Various
Noon	Adjourn	

T-14 <i>Alabama A</i>	AASHTO Technical Committee for Structural Steel Design Thomas Macioce, Pennsylvania DOT Chair Tuesday, June 25, 2019 1:00 p.m.–5:00 p.m.
---------------------------------	--

1:00–1:15 p.m.	Introductions and Opening Remarks	Tom Macioce <i>Chair</i>
1:15–1:50 p.m.	<ul style="list-style-type: none"> • Agenda Items and Editorials • Revisions to Articles 6.8.2.2 and C6.8.2.2 • Revisions to Articles 6.10.1.4 and C6.10.1.4 • Revisions to Articles 6.12.2.2.4 and C6.12.2.2.4 • Revisions to Articles 6.13.2.9, C6.13.2.9, C6.13.6.1.3b, 6.13.6.1.3c, and C6.13.6.1.3c • Miscellaneous items 	Mike Grubb
1:50–2:00 p.m.	AASHTO Fabrication Specification	Heather Gilmer

(T-14 Agenda cont'd)

(T-14 Agenda cont'd)

2:00–2:15 p.m.	Concrete-Filled Steel Tubes	Tom Murphy
2:15–2:45 p.m.	Final LRFD Specifications for Noncomposite Box Section Members Containing Longitudinally Stiffened Plates	Don White and Tony Ream
2:45–3:15 p.m.	Break	
3:15–3:45 p.m.	Question and Answers Regarding Final LRFD	Don White and Tony Ream
3:45–4:00 p.m.	Question and Answers regarding Final LRFD Specifications for Noncomposite Box Section Members Containing Longitudinally Stiffened Plates	Committee
4:00–4:20 p.m.	Collaboration Update <ul style="list-style-type: none"> G4.1 Steel Bridge Fabrication QC/QA Guide G13.1 Steel Girder Bridge Analysis S10.1 Erection Guide Specification 	Ronnie Medlock and Brandon Chavel
4:20–4:30 p.m.	T-18 Ballot Item Regarding End Panel Shear Capacity	Matt Farrar
4:30–4:50 p.m.	FHWA FC Memo and TAs	Dayi Wang
4:50–5:00 p.m.	Open Discussion	Committee
5:00 p.m.	Adjourn	

T-15 <i>Alabama B</i>	<i>AASHTO Technical Committee for Substructures and Retaining Walls</i> Tony M. Allen, Washington State DOT, Chair Tuesday, June 25, 2019 8:00 a.m.–Noon
---------------------------------	--

8:00 a.m.–8:10 a.m.	Introductions and Opening Remarks	Tony Allen <i>Chair</i>
8:10 a.m.–8:40 a.m.	Rewrite and Update of Section 10.4—Soil and Rock Properties	Dr. Erik Loehr
8:40 a.m.–9:15 a.m.	Large Diameter Pile Research Results and Recommendations	Kathryn Petek <i>Shannon and Wilson</i>
9:15 a.m.–9:45 a.m.	Bridge Scour Risk Management—NCHRP 15-02 Scan Results	NCHRP Scan 15-02 Team Rebecca Curtis <i>Michigan DOT</i>
9:45 a.m.–10:00 a.m.	Break	

(T-15 Agenda cont'd)



(T-15 Agenda cont'd)

10:00 a.m.–11:00 a.m.	T15 Ballot Items—MSE Wall Internal Stability Items—Discussion and Vote	Scott Hidden <i>North Carolina DOT</i>
11:00 a.m.–11:30 a.m.	T15 Ballot Item—Soil Nail Wall Construction—Discussion and Vote	Tony Allen <i>Chair</i>
11:30 a.m.–11:45 a.m.	T15 Ballot Item—Minor Items—Discussion and Vote	Tony Allen <i>Chair</i>
11:45 a.m.–Noon	T15 Closed Session for Future Planning	Committee
Noon	Adjourn	

T-16 <i>Alabama E</i>	<i>AASHTO Technical Committee for Timber Structures</i> Thomas Macioce, Pennsylvania DOT Chair Monday, June 24, 2019 8:00 a.m.–9:30 a.m.
---------------------------------	--

8:00–8:10 a.m.	Welcome and Introductions	Tom Macioce <i>Chair</i>
8:10–9:15 a.m.	Agenda Item Section 8 Proposed Revision and Comments	Committee
9:15–9:30 a.m.	New Business	Committee
9:30 a.m.	Adjourn	

T-17 <i>Alabama C</i>	<i>AASHTO Technical Committee for Metals Fabrication</i> Alexander Bardow, Massachusetts DOT, Chair Tuesday, June 26, 2018 8:00 a.m.–Noon
---------------------------------	---

8:00 a.m.	Welcome and Introductions	Alexander Bardow <i>Chair</i>
8:10 a.m.	Approval of Minutes from 2018 Annual Meeting	Alexander Bardow <i>Chair</i>
8:15 a.m.	SC 10 Committee Report	Ronnie Medlock <i>SC 10 Vice Chair</i>
8:45 a.m.	T-17 Ballot Review	Ronnie Medlock <i>SC 10 Vice Chair</i>
9:05 a.m.	FHWA Research Update	FHWA

(T-17 Agenda cont'd)

(T-17 Agenda cont'd)

9:35 a.m.	Other Research Updates	Various
9:45 a.m.	Break	
10:15 a.m.	Review of Draft Metals Fabrication Specifications	Committee
11:45 a.m.	2019 T-17 Mid-Year Meeting	Alexander Bardow Chair
11:50 a.m.	Old Business	Alexander Bardow Chair
11:55 a.m.	New Business	Alexander Bardow Chair
Noon	Adjourn	

T-18 <i>Alabama A</i>	AASHTO Technical Committee for Bridge Management, Evaluation, and Rehabilitation Matthew M. Farrar, Idaho DOT, Chair Tuesday, June 25, 2019 8:00 a.m.–Noon	
---------------------------------	--	--

8:00 a.m.	Welcome and Introductions	Matt Farrar Chair
8:05 a.m.	<ul style="list-style-type: none"> Approval of 2018 Minutes (Burlington, VT) Approval of 2018 Midyear Minutes (Boise, ID) 	Matt Farrar Chair
8:10 a.m.	Discussion of Agenda Items: <ul style="list-style-type: none"> T18-1 ER Vehicles T18-2 Steel Girder End Panel Shear T18-3 MBE Appendix A, Ex A1 T18-4 MBE Appendix A, Ex A7 T18-5 MBE Buried Culverts 	Matt Farrar Chair
8:35 a.m.	NCHRP 20-07 Task 410 Calibration of Load Factors for the FAST Act EV-2 & EV-3	Bala Sivakumar HNTB
9:00 a.m.	FHWA Updates: <ul style="list-style-type: none"> Coding Guide Update Asset Management and TAMP Issues NBIS Update UAV (Drones) FHWA Memo regarding Timeframe for placing Posting Signs Cross-Over Tunnel Issues for Bridge Inspectors 	Shay Burrows FHWA

(T-18 Agenda cont'd)



(T-18 Agenda cont'd)

9:25 a.m.	BrM and BrR Updates and Implementation	Eric Christie and Todd Thompson <i>AASHTOWare Task Force</i>
9:55 a.m.	Break	
10:05 a.m.	<ul style="list-style-type: none"> • MBEI 2nd Additional Defect Photos and Condition States • Pooled-Fund Study for Risk Based Bridge Inspection Intervals Implementation 	Glenn Washer <i>University of Missouri</i>
10:35 a.m.	NCHRP 15-54 Proposed Modification to AASHTO <i>Culvert Load Rating Specifications</i>	Mark Mlynarski <i>Michael Baker, Jr. Inc.</i>
11:05 a.m.	NDE and Smart Bridge Technology and MBE Section 5 Materials Testing	Hoda Azari <i>FHWA</i>
11:25 a.m.	<ul style="list-style-type: none"> • Guide Spec for Internally Redundant Members—Additions • Pooled-Fund Study Regarding Pack Rust • Recap Load Rating of Rail Cars 	Rob Connor <i>Purdue</i>
11:45 a.m.	Recap	Matt Farrar <i>Chair</i>
Noon	Adjourn	

T-19 <i>Alabama B</i>	AASHTO Technical Committee for Software and Technology Scot Becker, Wisconsin DOT, Chair Monday, June 24, 2019 1:00 p.m.–5:00 p.m.
---------------------------------	--

1:00 p.m.	Welcome and Introductions	Scot Becker <i>Wisconsin DOT, Chair</i>
1:05 p.m.	Alabama Technology Showcase: <i>The Portable Bridge WIM</i>	Eric Christie <i>Alabama DOT</i> Robert Taylor <i>Cestel</i>
1:30 p.m.	BIM for Bridges and Structures Initiative—Pooled-Fund Update	Julie Rivera and Connor Christian <i>HDR</i>
2:30 p.m.	FHWA Project: <i>BIM for Bridges Demonstration</i>	Brian Kozy <i>FHWA</i> Joe Brenner <i>WSP</i>

(T-19 Agenda cont'd)

(T-19 Agenda cont'd)

3:00 p.m.	Break	
3:20 p.m.	BIM for Bridges and Structures Pilot Project Updates—Utah DOT	Mark Daniels <i>Utah DOT</i>
3:40 p.m.	I-80/I-380 Interchange BIM 3D Pilot Project—Iowa DOT	Ahmad Abu-Hawash <i>Iowa DOT</i>
4:00 p.m.	Model Based Contracting at NYSDOT—Rt. 28 over Esopus Creek Bridge Replacement—New York State DOT	Brenda Crudele <i>New York State DOT</i>
4:20 p.m.	AASHTOWare Bridge Update	Todd Thompson <i>South Dakota DOT</i>
4:40 p.m.	Closing Remarks	Scot Becker <i>Wisconsin DOT, Chair</i>
5:00 p.m.	Adjourn	

T-20 <i>Alabama C</i>	AASHTO Technical Committee for Tunnels Lou Ruzzi, P.E., Pennsylvania DOT, Chair Tuesday, June 25, 2019 1:00 p.m.–5:00 p.m.
---------------------------------	--

1:00 p.m.	Welcome and Introductions	Lou Ruzzi, P.E. <i>PennDOT, Chair</i>
1:05 p.m.	Research Priorities/Strategic Plan Update	T-20
2:15 p.m.	Adhesive Anchors Policy	Bill Bergeson, P.E. <i>FHWA</i>
2:45 p.m.	Break	
3:15 p.m.	FHWA Update	Bill Bergeson, P.E. <i>FHWA</i>
3:45 p.m.	AFF60 Update	Conrad Felice P.E., Ph.D.
4:00 p.m.	Update of VDOT's Tunnel Cracking Problem Closed Session	Prasad Nallapaneni, P.E.
4:30 p.m.	Proposed Changes to <i>LRFD Manual</i> Closed Session	Lou Ruzzi <i>PennDOT, Chair</i>
4:45 p.m.	Discussion on 2020 Mid-Year Meeting Closed Session	Committee
5:00 p.m.	Adjourn	



John James Audubon Bridge
St. Francisville, Louisiana
Program and Construction
Management for Owner

DELIVERING INNOVATIVE SOLUTIONS ON TIME AND WITHIN BUDGET ACROSS THE LIFE CYCLE OF ROUTINE AND COMPLEX BRIDGES

Michael Baker
INTERNATIONAL

Proud Gold Sponsor of the AASHTO COBS

MTBAKERINTL.COM



Elba Bypass Bridges
Elba, Alabama

A long-standing tradition of providing sound, effective and innovative structural engineering services and solutions for a variety of bridge projects.

- Bridge Design
- Bridge Inspection
- Bridge Analysis & Load Rating
- Construction Oversight & Management
- Design Build & P3
- Railroad Bridges
- Walls & Retaining Structures
- Design & Plan Reviews
- Hydraulic Analysis & Evaluations
- Value Engineering
- Contractor Design Support
- Asset Management

**FOR
MORE
INFORMATION,
CONTACT:**

Mary Margaret Nicholson, PE
VP, Structural Engineer Manager
mary.nicholson@neel-schaffer.com | 205-912-8558
www.neel-schaffer.com

Building 100-year steel bridges
for over 100 years.
.....
www.aisc.org/100yearbridge

Eads Bridge | St. Louis, MO
Dedicated 1874.



**Smarter.
Stronger.
Steel.**

General Session Proceedings

(As of 6/6/19)

Please Note: Ballot items are indicated by sequential numbers.

Wednesday, June 26, 2019, Alabama AB

1:00 p.m.–2:45 p.m.	
	Welcome by Chairman—Carmen Swanwick, Chair, Utah DOT
	Alabama Welcome—Don Arkle, Chief Engineer, Alabama DOT
	Roll Call—Joey Hartmann, Liaison, FHWA
	Service Resolutions and Remarks by Chairman—Carmen Swanwick, Chair, Utah DOT
	FHWA Update—Joey Hartmann, Liaison, FHWA
1	T-4 Committee (Construction)— <i>AASHTO Guide Design Specifications for Bridge Temporary Works</i> : Section 2, Article 2.3.5.2, and Appendix C and E—Carmen Swanwick, T-4 Chair, Utah DOT
2	T-5 Committee (Loads and Load Distribution)— <i>LRFD Bridge Design Specifications</i> : Section 3, Articles 3.3.1, 3.6.5.1, 3.6.5.2 and 3.16—Jeff Robert, T-5 Chair, Maryland DOT
3	T-9 Committee (Bridge Preservation)— <i>Guide for Design and Construction of Near-Surface Mounted Titanium Alloy Bars for Strengthening Concrete Structures</i> —Jim Nelson, T-9 Chair, Iowa DOT
4	T-9 Committee (Bridge Preservation)— <i>Historic Bridge Preservation Guide Specification</i> —Jim Nelson, T-9 Chair, Iowa DOT
5	T-9 Committee (Bridge Preservation)— <i>Guide Specification for Service Life Design of Highway Bridges</i> —Jim Nelson, T-9 Chair, Iowa DOT
6	T-9 Committee (Bridge Preservation)— <i>Guide to Bridge Preservation Actions</i> —Jim Nelson, T-9 Chair, Iowa DOT
2:45 p.m.–3:15 p.m. Break	
3:15 p.m.–5:00 p.m.	
	PennDOT P3 Bridge Replacement—Tom Macioce, Pennsylvania DOT
7	T-10 Committee (Concrete Design)— <i>LRFD Bridge Design Specifications</i> : Section 5, Article 5.10.4.3 (WAI 199)—Kevin Western, T-10 Chair, Minnesota DOT
8	T-10 Committee (Concrete Design)— <i>LRFD Bridge Design Specifications</i> : Section 5, Various Articles (WAI 195A)—Kevin Western, T-10 Chair, Minnesota DOT
9	T-10 Committee (Concrete Design)/T-4 (Construction)— <i>LRFD Bridge Construction Specifications</i> : Section 10, Articles 10.3.2, 10.3.2.1 and 10.3.2.2 / <i>LRFD Bridge Design Specifications</i> : Section 5, Article 5.9.5.6.1 (WAI 197)—Kevin Western, T-10 Chair, Minnesota DOT



	TRB Update—Waseem Dekelbab, TRB
	FHWA Research Update—Ben Graybeal, FHWA
10	T-11 Committee (Research)—Anne Rearick, T-11 Chair, Indiana DOT
11	T-12 Committee (Structural Supports for Highway Signs, Luminaires, and Traffic Signals)— <i>LRFD Specifications for Structural Supports for Highway Signs, Luminaires, and Traffic Signals</i> : Section 3, Article C3.7 (WAI LRFD 14)—Sam Fallaha, T-12 Chair, Florida DOT
12	T-12 Committee (Structural Supports for Highway Signs, Luminaires, and Traffic Signals)— <i>Standard Specifications for Structural Supports for Highway Signs, Luminaires, and Traffic Signals</i> : Section 5, Article 5.15.5 (WAI SLTS 05)—Sam Fallaha, T-12 Chair, Florida DOT
13	T-12 Committee (Structural Supports for Highway Signs, Luminaires, and Traffic Signals)— <i>LRFD Specifications for Structural Supports for Highway Signs, Luminaires, and Traffic Signals</i> : Section 6, Table 6.5.1-12 (WAI LRFD 28)—Sam Fallaha, T-12 Chair, Florida DOT
14	T-12 Committee (Structural Supports for Highway Signs, Luminaires, and Traffic Signals)— <i>LRFD Specifications for Structural Supports for Highway Signs, Luminaires, and Traffic Signals</i> : Section 14, Article 14.4.4.8 (WAI LRFD 09)—Sam Fallaha, T-12 Chair, Florida DOT

End of Day

Thursday, June 27, 2019

8:00 a.m.–9:45 a.m.

	Birmingham CBD Bridge Replacement Project—Tim Colquett, Alabama DOT; Lloyd Pitts, Volkert Engineering; Eric Johnson, Corven Engineering
15	T-13 Committee (Culverts)/T-5 Committee (Loads and Load Distribution)— <i>LRFD Bridge Design Specifications</i> : Section 3, Article 3.6.1.2.6a (WAI 19-01)—Jason Hastings, T-13 Chair, Delaware DOT
16	T-13 Committee (Culverts)— <i>LRFD Bridge Design Specifications</i> : Section 3, Article 3.6.1.2.6a (WAI 19-02)—Jason Hastings, T-13 Chair, Delaware DOT
17	T-13 Committee (Culverts)— <i>LRFD Bridge Design Specifications</i> : Section 12, Articles C12.1, 12.6.4 and 12.16 (WAI 19-12)—Jason Hastings, T-13 Chair, Delaware DOT
18	T-13 Committee (Culverts)— <i>LRFD Bridge Design Specifications</i> : Section 12, Articles 12.2, 12.6.9 and 12.16 (WAI 19-11)—Jason Hastings, T-13 Chair, Delaware DOT
19	T-13 Committee (Culverts)— <i>LRFD Bridge Design Specifications</i> : Articles 12.4.2.10, C12.7.2.1 and C12.7.2.7 (WAI 19-10)—Jason Hastings, T-13 Chair, Delaware DOT
20	T-13 Committee (Culverts)— <i>LRFD Bridge Design Specifications</i> : Section 12, Article 12.5.4 (WAI 19-03)—Jason Hastings, T-13 Chair, Delaware DOT
21	T-13 Committee (Culverts)— <i>LRFD Bridge Design Specifications</i> : Section 12, Article 12.12.3.5 (WAI 19-09)—Jason Hastings, T-13 Chair, Delaware DOT

22	T-13 Committee (Culverts)— <i>LRFD Bridge Design Specifications</i> : Section 12, Article C12.12.3.5 (WAI 19-07)— Jason Hastings, T-13 Chair, Delaware DOT
23	T-13 Committee (Culverts)— <i>LRFD Bridge Design Specifications</i> : Section 12, Article 12.12.3.10.2b (WAI 19-06)— Jason Hastings, T-13 Chair, Delaware DOT
24	T-13 Committee (Culverts)/T-4 Committee (Construction)— <i>LRFD Bridge Construction Specifications</i> : Section 27, Article C27.6.1 (WAI 19-05)—Jason Hastings, T-13 Chair, Delaware DOT
25	T-13 Committee (Culverts)—Culvert and Storm Drain System Inspection Guide: Appendices A and B (WAI 19-13)— Jason Hastings, T-13 Chair, Delaware DOT
	Sunshine Bridge Emergency Repair—Zhengzheng (Jenny) Fu, Louisiana DOT
	Alaska DOT & PF Earthquake Response—Rich Pratt, Alaska DOT & PF
9:45 a.m.–10:15 a.m. Break	
10:15 a.m.–Noon	
26	T-14 Committee (Structural Steel Design)/T-10 Committee (Concrete Design)— <i>LRFD Bridge Design Specifications</i> : Section 4, Article 4.5.3.2.2b; Section 5, Articles C5.7.2.1 and 5.12.9.5.2; Section 6, Various Articles—Tom Macioce, T-14 Chair, Pennsylvania DOT
27	T-14 Committee (Structural Steel Design)— <i>LRFD Bridge Design Specifications</i> : Section 6, Articles 6.3 and 6.8.2.2—Tom Macioce, T-14 Chair, Pennsylvania DOT
28	T-14 Committee (Structural Steel Design)— <i>LRFD Bridge Design Specifications</i> : Section 6, Article 6.10.1.4—Tom Macioce, T-14 Chair, Pennsylvania DOT
29	T-14 Committee (Structural Steel Design)— <i>LRFD Bridge Design Specifications</i> : Section 6, Articles 6.3 and 6.12.2.2.4—Tom Macioce, T-14 Chair, Pennsylvania DOT
30	T-14 Committee (Structural Steel Design)— <i>LRFD Bridge Design Specifications</i> : Section 6, Articles 6.3, 6.13.2.9 and 6.13.6.1.3—Tom Macioce, T-14 Chair, Pennsylvania DOT
31	T-14 Committee (Structural Steel Design)— <i>LRFD Bridge Design Specifications</i> : Section 6, Various Articles (1)—Tom Macioce, T-14 Chair, Pennsylvania DOT
32	T-14 Committee (Structural Steel Design)— <i>LRFD Bridge Design Specifications</i> : Section 6, Various Articles (2)—Tom Macioce, T-14 Chair, Pennsylvania DOT
33	T-14 Committee (Structural Steel Design)— <i>AASHTO/NSBA Steel Bridge Collaboration Guide: G4.1—Steel Bridge Fabrication QC/QA Guidelines</i> —Tom Macioce, T-14 Chair, Pennsylvania DOT
34	T-14 Committee (Structural Steel Design)— <i>AASHTO/NSBA Steel Bridge Collaboration Guide: S10.1—Steel Bridge Erection Guide Specification</i> —Tom Macioce, T-14 Chair, Pennsylvania DOT
35	T-14 Committee (Structural Steel Design)— <i>AASHTO/NSBA Steel Bridge Collaboration Guide: G13.1—Guidelines for Steel Girder Bridge Analysis</i> —Tom Macioce, T-14 Chair, Pennsylvania DOT



	Champ Clark Bridge Project—Dennis Heckman, Missouri DOT
36	T-15 Committee (Substructures and Retaining Walls)— <i>LRFD Bridge Design Specifications</i> : Section 3, Article 3.4.1—Tony Allen, T-15 Chair, Washington DOT
37	T-15 Committee (Substructures and Retaining Walls)— <i>LRFD Bridge Design Specifications</i> : Section 3, Articles 3.4.1 and 3.11.5.8.2—Tony Allen, T-15 Chair, Washington DOT
38	T-15 Committee (Substructures and Retaining Walls)— <i>LRFD Bridge Design Specifications</i> : Section 11, Various Articles (1)—Tony Allen, T-15 Chair, Washington DOT
39	T-15 Committee (Substructures and Retaining Walls)— <i>LRFD Bridge Design Specifications</i> : Section 11, Various Articles (2)—Tony Allen, T-15 Chair, Washington DOT
40	T-15 Committee (Substructures and Retaining Walls)— <i>LRFD Bridge Design Specifications</i> : Section 11, Articles 11.12.7.2 and 11.12.9—Tony Allen, T-15 Chair, Washington DOT
41	T-15 Committee (Substructures and Retaining Walls)— <i>LRFD Bridge Construction Specifications</i> : New Section 34; Section 7, Articles 7.5.5, 7.6.5 and 7.8—Tony Allen, T-15 Chair, Washington DOT
Noon–1:00 p.m. Lunch	
1:00 p.m.–2:30 p.m.	
	Mobile River Bridge—Pat Hickox, HDR
42	T-16 Committee (Timber Structures)— <i>LRFD Bridge Design Specifications</i> : Section 8, Various Articles—Tom Macioce, T-14 Chair, Pennsylvania DOT
	Global Benchmarking Program: Electrically Isolated Tendons in European Highway Structures—Kevin Western, Minnesota DOT
43	T-17 Committee (Welding)— <i>D1.5 Bridge Welding Code</i> : Clause 1.2.2 (R42)—Alex Bardow, T-17 Chair, Massachusetts DOT
44	T-17 Committee (Welding)— <i>D1.5 Bridge Welding Code</i> : Clauses 1, 2 and 5, Various Locations (R26 & R46)—Alex Bardow, T-17 Chair, Massachusetts DOT
45	T-17 Committee (Welding)— <i>D1.5 Bridge Welding Code</i> : Clause 2, Various Locations (R36)—Alex Bardow, T-17 Chair, Massachusetts DOT
46	T-17 Committee (Welding)— <i>D1.5 Bridge Welding Code</i> : Clauses 2, 3, 4, 5, 6, 7 and 12 (R16)—Alex Bardow, T-17 Chair, Massachusetts DOT
47	T-17 Committee (Welding)— <i>D1.5 Bridge Welding Code</i> : Clauses 2, 3, 5, 6; Annexes D, K and M (R29)—Alex Bardow, T-17 Chair, Massachusetts DOT
48	T-17 Committee (Welding)— <i>D1.5 Bridge Welding Code</i> : Clauses 3.4.8 and 3.7.3, Commentaries C-3.2.7, C-3.4.8 and C-3.7.3 (R40)—Alex Bardow, T-17 Chair, Massachusetts DOT

49	T-17 Committee (Welding)— <i>D1.5 Bridge Welding Code</i> : Clauses 3, 4 and 5 (R34)— Alex Bardow, T-17 Chair, Massachusetts DOT
50	T-17 Committee (Welding)— <i>D1.5 Bridge Welding Code</i> : Clauses 3, 4, 5, 6, 7 and 12, Various Locations (R37)— Alex Bardow, T-17 Chair, Massachusetts DOT
51	T-17 Committee (Welding)— <i>D1.5 Bridge Welding Code</i> : Clauses 5.12.1 and 5.12.2; Table 5.10 (R39)— Alex Bardow, T-17 Chair, Massachusetts DOT
52	T-17 Committee (Welding)— <i>D1.5 Bridge Welding Code</i> : CClause 5.21.5 (R31)— Alex Bardow, T-17 Chair, Massachusetts DOT
53	T-17 Committee (Welding)— <i>D1.5 Bridge Welding Code</i> : Clause 5.23.3 (R33)— Alex Bardow, T-17 Chair, Massachusetts DOT
54	T-17 Committee (Welding)— <i>D1.5 Bridge Welding Code</i> : Clause 6, Various Locations (R13)— Alex Bardow, T-17 Chair, Massachusetts DOT
55	T-17 Committee (Welding)— <i>D1.5 Bridge Welding Code</i> : Clauses K7.4 and C-K7.4 (R35)— Alex Bardow, T-17 Chair, Massachusetts DOT
2:30 p.m.–3:00 p.m. Break	
	Ballot Item Pulled
56	T-18 Committee (Bridge Management, Evaluation, and Rehabilitation)— <i>The Manual for Bridge Evaluation</i> : Section 6, Various Articles (1)— Matt Farrar, T-18 Chair, Idaho DT
57	T-18 Committee (Bridge Management, Evaluation, and Rehabilitation)— <i>The Manual for Bridge Evaluation</i> : Section 6, Various Articles (2)— Matt Farrar, T-18 Chair, Idaho DT
58	T-18 Committee (Bridge Management, Evaluation, and Rehabilitation)— <i>The Manual for Bridge Evaluation</i> : Appendix A, Example A1— Matt Farrar, T-18 Chair, Idaho DT
59	T-18 Committee (Bridge Management, Evaluation, and Rehabilitation)— <i>The Manual for Bridge Evaluation</i> : Appendix A, Example A7— Matt Farrar, T-18 Chair, Idaho DT
	Editorials—Tom Murphy, Modjeski & Masters
	Announcement of 2020 Committee on Bridges & Structures Meeting in Alabama—Dennis Heckman, Missouri DOT
	Closing—Carmen Swanwick, Chair, Utah DOT

Engineering the future of infrastructure

Segment erection for the I-59/I-20 bridge through the Central Business District of Birmingham, Ala.
(Photo courtesy of Corven Engineering)

- ▼ TRANSPORTATION
- ▼ ENERGY
- ▼ WATER
- ▼ ENVIRONMENT

VOLKERT

866.VOLKERT ▼ VOLKERT.COM

2019 AASHTO *Committee on Bridges and Structures:*

Members

ALABAMA				
Tim Colquett	State Bridge Engineer	(334) 242-6007	colquettw@dot.state.al.us	Voting
Eric Christie	Deputy State Maintenance Engineer	(334) 242-6281	christiee@dot.state.al.us	Non-Voting
Randall Mullins	Assistant State Bridge Engineer	(334) 242-6004	mullinsr@dot.state.al.us	Non-Voting
ALASKA				
Richard A. Pratt	Chief Bridge Engineer	(907) 465-8890	richard.pratt@alaska.gov	Voting
Leslie Daugherty	Senior Bridge Engineer	(907) 465-8891	leslie.daugherty@alaska.gov	Non-Voting
Elmer E. Marx	Senior Bridge Engineer	(907) 465-6941	elmer.marx@alaska.gov	Non-Voting
ARIZONA				
David L. Eberhart	State Bridge Engineer	(602) 712-7654	deberhart@azdot.gov	Voting
David Benton	Assistant State Bridge Engineer	(602) 712-7910	dbenton@azdot.gov	Non-Voting
Pe-Shen Yang	Assistant State Bridge Engineer	(602) 712-8606	pyang@azdot.gov	Non-Voting
ARKANSAS				
Rick Ellis	Division Head—Bridge	(501) 569-2361	Rick.Ellis@ardot.gov	Voting
Michael Hill	State Heavy Bridge Maintenance Engineer	(501) 569-2466	mike.hill@ardot.gov	Non-Voting
Joe Sartini	State Maintenance Engineer	(501) 569-2231	Joe.Sartini@ardot.gov	Non-Voting
CALIFORNIA				
Thomas A. Ostrom	State Bridge Engineer	(916) 227-8728	tom.ostrom@dot.ca.gov	Voting
Gudmund Setberg	Supervising Bridge Engineer	(916) 227-8807	gudmund.setberg@dot.ca.gov	Non-Voting
Dolores Valls	State Bridge Maintenance Engineer	(916) 997-8188	dolores.valls@dot.ca.gov	Non-Voting
COLORADO				
Michael Collins	State Bridge Engineer	(303) 757-9190	michael.collins@state.co.us	Voting
Stephen Harelson	West Program Engineer	(720) 497-6913	stephen.harelson@state.co.us	Non-Voting
Jessica Martinez	Asset Management Engineer	(303) 757-9191	jessica.martinez@state.co.us	Non-Voting
CONNECTICUT				
Timothy Fields	Principal Engineer	(860) 594-3217	timothy.fields@ct.gov	Voting
Mary E. Baker	Principal Engineer	(860) 594-3402	mary.baker@ct.gov	Non-Voting
DELAWARE				
Jason N. Hastings	State Bridge Engineer	(302) 760-2310	Jason.Hastings@state.de.us	Voting



Jason Arndt	Bridge Management Engineer	(302) 760-2309	jason.arndt@state.de.us	Non-Voting
Craig A. Stevens	Bridge Design Engineer	(302) 760-2322	craig.stevens@state.de.us	Non-Voting
DISTRICT OF COLUMBIA				
Konjit Eskender	Project Engineer	(202) 671-4568	konjit.eskender@dc.gov	Voting
Don L. Cooney	Structural Engineer	(202) 671-4681	donald.cooney@dc.gov	Non-Voting
Richard Kenney	Senior Bridge Engineer	(202) 671-2249	richard.kenney@dc.gov	Non-Voting
FLORIDA				
Sam Fallaha	Assistant State Structures Design Engineer	(850) 414-4296	sam.fallaha@dot.state.fl.us	Voting
William Potter	Assistant State Structures Design Engineer	(850) 921-7106	william.potter@dot.state.fl.us	Non-Voting
Jeff A. Pouliotte	State Structures Maintenance Engineer	(850) 410-5691	jeffrey.pouliotte@dot.state.fl.us	Non-Voting
GEORGIA				
Bill DuVall	State Bridge Engineer	(404) 631-1883	bduvall@dot.ga.gov	Voting
Douglas D. Franks	State Bridge Maintenance Engineer	(404) 631-1917	dranks@dot.ga.gov	Non-Voting
Steve Gaston	Assistant State Bridge Engineer	(404) 631-1881	sgaston@dot.ga.gov	Non-Voting
HAWAII				
James Fu	Structural Engineer	(808) 692-7611	james.fu@hawaii.gov	Voting
Kevin Murata	Design Engineer	(808) 692-7613	kevin.a.murata@hawaii.gov	Non-Voting
John Williams	State Highway Maintenance Engineer	(808) 587-2183	john.williams@hawaii.gov	Non-Voting
IDAHO				
Matt M. Farrar	State Bridge Engineer	(208)334-8538	matt.farrar@itd.idaho.gov	Voting
ILLINOIS				
Carl Puzey	Bureau Chief of Bridges and Structures	(217) 782-2125	Carl.Puzey@illinois.gov	Voting
Tim Armbrecht	Engineer of Structural Services	(217) 782-2125	Tim.Armbrecht@illinois.gov	Non-Voting
Jayme Schiff	Engineer of Design	(217) 782-2125	Jayme.Schiff@illinois.gov	Non-Voting
INDIANA				
Anne M. Rearick	Director of Bridge Management	(317) 232-5152	arearick@indot.in.gov	Voting
Andrew Fitzgerald	Bridge Inspection Manager	(317) 499-1797	aFitzgerald@indot.in.gov	Non-Voting
Stephanie Wagner	Director of Bridge Management	(317) 233-2095	swagner@indot.in.gov	Non-Voting
IOWA				
James S. Nelson	State Bridge Engineer	(515) 239-1206	james.s.nelson@iowadot.us	Voting

Ahmad Abu-Hawash	Chief Structural Engineer	(515) 239-1393	ahmad.abu-hawash@iowadot.us	Non-Voting
KANSAS				
Mark E. Hoppe	Chief, Bureau of Structures & Geotechnical Services	(785) 296-3531	Mark.Hoppe@ks.gov	Voting
John Jones	State Bridge Design Engineer/Assistant Bureau Chief	(785) 806-5150	jjones@ksdot.org	Non-Voting
KENTUCKY				
Bart Asher	Director, Division of Structure Design	(502) 782-3812	bart.asher@ky.gov	Voting
Andy Barber	State Highway Engineer	(502) 564-4890	andy.barber@ky.gov	Non-Voting
Marvin Wolfe	Division of Structural Design	(502) 564-4560	Marvin.Wolfe@ky.gov	Non-Voting
LOUISIANA				
Zheng Zheng Fu	Assistant Bridge Design Administrator	(225) 938-4669	zhengzheng.fu@la.gov	Voting
Artur D'Andrea	Assistant Bridge Engineer	(225) 937-5582	Arthur.DAndrea@la.gov	Non-Voting
Chris Guidry	Assistant Bridge Design Administrator	(225) 379-328	chris.guidry@la.gov	Non-Voting
MAINE				
Wayne L. Frankhauser	Bridge Program Manager	(207) 624-3490	wayne.frankhauserjr@maine.gov	Voting
Jeff S. Folsom	Assistant Bridge Program Manager	(207) 624-3394	jeff.folsom@maine.gov	Non-Voting
Michael H. Wight	Senior Project Manager	(207) 592-2543	michael.wight@maine.gov	Non-Voting
MARYLAND				
Maurizio Agostino	Deputy Director	(410) 545-8308	magostino@sha.state.md.us	Voting
Jesse Creel		(410) 545-8379	jcreel@sha.state.md.us	Non-Voting
Jeffery Robert	Division Chief—New Design	(410) 545-8327	jrobert@sha.state.md.us	Non-Voting
MASSACHUSETTS				
Alexander K. Bardow	State Bridge Engineer	(857) 368-9430	alexander.bardow@state.ma.us	Voting
Joe Rigney	Tunnel Engineer	(857) 368-9308	Joseph.Rigney@dot.state.ma.us	Non-Voting
MICHIGAN				
Matthew Chynoweth	Chief Bridge Engineer	(517) 243-4302	chynowethm@michigan.gov	Voting
Rebecca Curtis	Administrator, Office of Bridge Preservation and Management	(571) 449-5243	curtisr4@michigan.gov	Non-Voting
Richard E. Liptak	TC TSC Manager	(231) 590-3382	LiptakR@michigan.gov	Non-Voting
MINNESOTA				
Kevin L. Western	State Bridge Engineer	(651) 366-4501	kevin.western@state.mn.us	Voting



Arielle Ehrlich	State Bridge Design Engineer	(651) 366-4506	arielle.ehrlich@state.mn.us	Non-Voting
Ed Lutgen	Bridge Construction and Maintenance Engineer	(651) 366-4507	edward.lutgen@state.mn.us	Non-Voting
MISSISSIPPI				
Justin Walker	Director of Structures, State Bridge Engineer	(601) 359-7200	jmwalker@mdot.ms.gov	Voting
Scott Westerfield	Deputy Director of Structures, Assistant State Bridge Engineer	(601) 359-7200	swesterfield@mdot.ms.gov	Non-Voting
MISSOURI				
Dennis Heckman	State Bridge Engineer	(573) 751-4676	dennis.heckman@modot.mo.gov	Voting
Greg E. Sanders	Structural Development and Support Engineer	(573) 526-0245	gregory.sanders@modot.mo.gov	Non-Voting
MONTANA				
Stephanie Brandenberger	Bridge Engineer	(406) 444-6260	sbrandenberger@mt.gov	Voting
Amanda Jackson	Bridge Management Engineer	(406) 444-9219	amjackson@mt.gov	Non-Voting
Dustin E. Rouse	Preconstruction Engineer	(406) 444-6005	drouse@mt.gov	Non-Voting
NEBRASKA				
Mark J. Traynowicz	Engineer, Bridge Division	(402) 479-4701	Mark.Traynowicz@nebraska.gov	Voting
Mark Ahlman	Assistant Bridge Engineer—Design	(402) 479-3936	Mark.Ahlman@nebraska.gov	Non-Voting
Fouad Jaber	Assistant State Bridge Engineer	(402) 479-3967	Fouad.Jaber@nebraska.gov	Non-Voting
NEVADA				
Jessen Mortensen	Bridge Inspection Engineer	(775) 888-7543	jmortensen@dot.nv.gov	Voting
Troy Martin		(775) 888-7380	tmartin@dot.nv.gov	Non-Voting
NEW HAMPSHIRE				
Robert Landry	Administrator Bureau of Bridge Design	(603) 271-3921	Robert.Landry@dot.nh.gov	Voting
David L. Scott	In-House Design Chief, Bridge Design Bureau	(603) 271-2731	David.Scott@dot.nh.gov	Non-Voting
NEW JERSEY				
Eddy Germain	Director Bridge Engineering and Infrastructure Mgmt	(609) 530-2561	eddy.germain@dot.nj.gov	Voting
Xiaohua "Hannah" Cheng	Project Engineer	(609) 963-1316	Xiaohua.Cheng@dot.nj.gov	Non-Voting
NEW MEXICO				
Shane Kuhlman	State Bridge Engineer	505-469-1542	shane.kuhlman@state.nm.us	Voting
Kathy Crowell	Design Section Manager	(505) 470-5663	kathy.crowell@state.nm.us	Non-Voting

Jeff C. Vigil	Bridge Management Engineer	(505) 490-2699	Jeff.Vigil@state.nm.us	Non-Voting
NEW YORK				
Richard Marchione	Director, Office of Structures	(518) 457-6827	Richard.Marchione@dot.ny.gov	Voting
Brenda Crudele	Director, Structures Design Bureau	(518) 457-4453	brenda.crudele@dot.ny.gov	Non-Voting
Ernest Holmberg	Subsurface Exploration Section Supervisor	(518) 457-4772	ernie.holmberg@dot.ny.gov	Non-Voting
NORTH CAROLINA				
Brian Hanks	State Structures Engineer	(919) 707-6400	bhanks@ncdot.gov	Voting
Scott Hidden	Support Services Supervisor, Geotechnical Engineering Unit	(919) 707-6856	shidden@ncdot.gov	Non-Voting
Girchuru Muchane	Assistant State Structures Engineer	(919) 707-6424	gmuchane@ncdot.gov	Non-Voting
NORTH DAKOTA				
Jon D. Ketterling	Bridge Engineer	(701) 328-4446	jketterl@nd.gov	Voting
Jason R. Thorenson	Assistant State Bridge Engineer	(701) 328-4760	jthorens@nd.gov	Non-Voting
OHIO				
Timothy J. Keller	Administrator, Office of Structural Engineering	(614) 466-2463	tim.keller@dot.ohio.gov	Voting
Alexander Dettloff	State Foundations Engineer	(614) 275-1308	Alexander.Dettloff@dot.ohio.gov	Non-Voting
Jeffrey E. Syar	Administrator, Office of Hydraulic Engineering	(614) 275-1373	jeffrey.syar@dot.state.oh.us	Non-Voting
OKLAHOMA				
Steve J. Jacobi	State Bridge Engineer	(405) 521-2606	sjacobi@odot.org	Voting
Walter L. Peters	Assistant Bridge Engineer—Maintenance	(405) 521-2606	wpeters@odot.org	Non-Voting
Tim Tegeler	Director of Engineering	(405) 521-6916	ttegeler@odot.org	Non-Voting
OREGON				
Albert Nako	Seismic Standards Engineer	(503) 986-3333	Albert.NAKO@odot.state.or.us	Non-Voting
Tanarat Potisuk	Prestressed Concrete Standards Engineer	(503) 986-3342	tanarat.potisuk@odot.state.or.us	Non-Voting
PENNSYLVANIA				
Thomas P. Macioce	Bridge Engineer	(717) 783-7615	tmacioce@pa.gov	Voting
Richard Runyen	Chief of Bridge Inspection	717-783-5006	rrunyen@pa.gov	Non-Voting
Louis J. Ruzzi	District Bridge Engineer	(412) 429-4893	lruzzi@pa.gov	Non-Voting



RHODE ISLAND				
Georgette K.Chahine	Managing Engineer	(401) 222-2053	georgette.chahine@dot.ri.gov	Voting
Keith Gaulin	Chief Civil Engineer	(401) 222-2053 x4068	keith.gaulin@dot.ri.gov	Non-Voting
SOUTH CAROLINA				
Terry B. Koon	Structural Design Support Engineer	(803) 737-4814	koontb@scdot.org	Voting
Hongfen Li	Structure Design Support Engineer	(803) 737-3976	lihongfen@scdot.org	Non-Voting
Jeff Sizemore	Geotechnical Design Support Engineer	(803) 737-1571	sizemoreJC@dot.state.sc.us	Non-Voting
SOUTH DAKOTA				
Steve Johnson	Chief Bridge Engineer	(605) 773-3285	steve.johnson@state.sd.us	Voting
Dave Madden		(605) 773-3285	Dave.Madden@state.sd.us	Non-Voting
Todd S. Thompson	Bridge Maintenance Engineer	(605) 773-3285	todd.thompson@state.sd.us	Non-Voting
TENNESSEE				
Ted A. Kniazewycz	Director—Structures Division	(615) 741-3351	Ted.Kniazewycz@tn.gov	Voting
TEXAS				
Graham Bettis	Bridge Division Director	(512) 416-2526	graham.bettis@txdot.gov	Voting
Bernie Carrasco	Bridge Inspection Branch Manager	(512) 416-2255	bernie.carrasco@txdot.gov	Non-Voting
Jamie F. Farris	Bridge Design Section Director	(512) 416-2433	jamie.farris@txdot.gov	Non-Voting
UTAH				
Carmen E.L. Swanwick	Deputy Project Development Director/ Chief Structural Engineer	(801) 633-6216	Cswanwick@utah.gov	Chair— Voting
Cheryl Hersh Simmons	Structures Design Manager	(801) 557-7846	cherylhersh@utah.gov	Non-Voting
Rebecca Nix	Bridge Management Engineer	(801) 633-2810	Rnix@utah.gov	Non-Voting
VERMONT				
Kristin M. Higgins	State Bridge Engineer	(802) 498-3398	kristin.higgins@vermont.gov	Voting
Jim Lacroix	Assistant State Bridge Engineer	(802) 272-4832	james.lacroix@vermont.gov	Non-Voting
VIRGINIA				
Kendal R. Walus	State Structure and Bridge Engineer	(807) 786-4575	kendal.walus@vdot.virginia.gov	Voting
Prasad L. Nallapaneni	Assistant State Structure and Bridge Engineer	(804) 371-2770	prasad.nallapaneni@vdot.virginia.gov	Non-Voting

Andrew M. Zickler	Complex Bridge Design and ABC Support Program Manager	(804) 371-2776	andy.zickler@vdot.virginia.gov	Non-Voting
WASHINGTON STATE				
Mark A. Gaines	State Bridge and Structures Engineer	(360) 705-7207	gainesm@wsdot.wa.gov	Voting
Tony M. Allen	State Geotechnical Engineer	(360) 709-5450	allent@wsdot.wa.gov	Non-Voting
Bijan Khaleghi	State Bridge Design Engineer	(360) 705-7181	khalegb@wsdot.wa.gov	Non-Voting
WEST VIRGINIA				
Tracy W. Brown	State Bridge Engineer	(304) 558-9490	Tracy.W.Brown@wv.gov	Voting
Ahmed Mongi	QA/QC Unit Leader, In-House Design	(304) 558-9739	Ahmed.N.Mongi@wv.gov	Non-Voting
WISCONSIN				
Scot Becker	Director, Bureau of Structures	(608) 266-5161	scot.becker@dot.wi.gov	Vice Chair—Voting
Bill C. Dreher	Chief Structures Design Engineer	(608) 266-8489	william.dreher@dot.wi.gov	Non-Voting
William L. Oliva	Chief of Structures Development Section	(608) 266-0075	william.olivia@dot.wi.gov	Non-Voting
WYOMING				
Michael E. Menghini	State Bridge Engineer	(307) 777-4427	Michael.Menghini@wyo.gov	Voting
Jeff R. Booher	Assistant State Bridge Engineer—Design	(307) 777-4044	jeff.booher@wyo.gov	Non-Voting
Paul Cortez	Assistant State Bridge Engineer	(307) 777-4049	Paul.Cortez@wyo.gov	Non-Voting

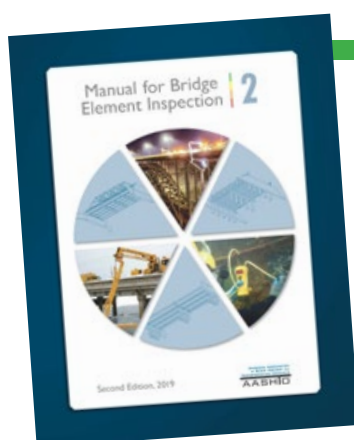

Manual for Bridge Element Inspection, 2nd Ed. Now Available!

Want more information about AASHTO publications? Here's three easy ways you can stay up-to-date on AASHTO Publications news...

1. [Visit the AASHTO Store online at https://store.transportation.org](https://store.transportation.org) for the latest news and updates!
2. [Download the latest AASHTO Publications Catalog!](#)
3. [join the AASHTO Publications Mailing List](#) to receive our monthly newsletter, digital Publications Catalog, and regular updates about new publications and special promotions!



2019 AASHTO *Committee on Bridges and Structures*: Associate Members

MARYLAND TRANSPORTATION AUTHORITY				
James Harkness	Director of Engineering	410-537-7870	jharkness@mdta.state.md.us	Non-Voting
MULTNOMAH COUNTY TRANSPORTATION DIVISION				
Jon Henrichsen	Bridge Services Manager	(503) 988-3757	jon.p.henrichsen@multco.us	Non-Voting
NEW YORK STATE BRIDGE AUTHORITY				
William Moreau	Chief Engineer	(845) 691-4077	bmoreau@nysba.ny.gov	Non-Voting
TRANSPORTATION RESEARCH BOARD				
Waseem Dekelbab	Senior Program Officer	(202) 334-1409	wdekelbab@nas.edu	Non-Voting
U.S. ARMY CORPS OF ENGINEERS				
Phillip W. Sauser	National Bridge Engineer	(651) 69-3447	phillip.w.sauser@usace.army.mil	Non-Voting
UNITED STATES COAST GUARD				
Kamal Elnahal	Chief, Bridge Program Engineering Division	(202) 372-1524	kamal.a.elnahal@uscg.mil	Non-Voting
USDA FOREST SERVICE				
John R. Katell		(703) 605-4614	jkattell@fs.fed.us	Non-Voting

SAVE THE DATE
AASHTO Committee on Bridges and Structures Annual Meeting
Branson, MO • June 1–4, 2020

Branson Convention Center
www.bransoncc.com

MoDOT

AASHTO

2019 AASHTO *Committee on Bridges and Structures*: FHWA (All Non-Voting)

FHWA Ex-Officio				
Joseph L. Hartmann	Director, Office of Bridges and Structures	(202) 366-4599	joey.hartmann@dot.gov	Liaison
Technical Committee Liaisons				
Sheila Rimal Duwadi	Team Leader, Bridge Safety, Reliability & Security	(202) 493-3106	sheila.duwadi@dot.gov	T-1
Vincent Chiarito	Senior Bridge Engineer	(202) 366-4621	vincent.chiarito@dot.gov	T-1
Tuong (Linh) Nguyen Warren	Structural Engineer	(202) 366-8501	tuonglinh.warren@dot.gov	T-2
Jia-Dzwan (Jerry) Shen	Senior Bridge Engineer—Seismic Specialist	(202) 366-4619	jerry.shen@dot.gov	T-3
Romeo Reyna Garcia	Bridge Construction Engineer	(202) 366-1342	romeo.garcia@dot.gov	T-4
Lubin Gao	Senior Bridge Engineer—Load Rating	(202) 366-4604	Lubin.Gao@dot.gov	T-5
Jamal I. Elkaissi	Structural Engineer	(720) 963-3272	jamal.elkaissi@dot.gov	T-6
Waider Wong	Senior Structural Engineer	(410) 962-9252	waider.wong@dot.gov	T-7
Brian Kozy	Team Leader, Structural Engineering Team	(202) 493-0341	Brian.Kozy@dot.gov	T-8
Raj Ailaney	Senior Bridge Preservation Engineer	(202) 366-6749	Raj.Ailaney@dot.gov	T-9
Reggie Holt	Senior Bridge Engineer—Concrete Specialist	(202) 366-4596	Reggie.Holt@dot.gov	T-10
Benjamin A. Graybeal	Structural Concrete Research Program Mgr	(202) 493-3122	benjamin.graybeal@dot.gov	T-11
Derek J. Soden	Senior Structural Engineer	(720) 963-3235	Derek.Soden@dot.gov	T-12
Anwar Ahmad	Technical Director, Structures Team	(202) 308-6717	anwar.ahmad@dot.gov	T-13
Dayi Wang	Senior Bridge Engineer—Steel Specialist	(202) 366-5604	dayi.wang@dot.gov	T-14
Justin Ocel	Structural Steel Research Program Manager	(202) 493-3080	justin.ocel@dot.gov	T-14
Silas Nichols	Principal Geotechnical Engineer	(202) 366-1554	Silas.Nichols@dot.gov	T-15
Sheila Rimal Duwadi	Team Leader, Bridge Safety, Reliability & Security	(202) 493-3106	sheila.duwadi@dot.gov	T-16
Justin Ocel	Structural Steel Research Program Manager	(202) 493-3080	justin.ocel@dot.gov	T-17
Shay Burrows	Team Leader, Structures Safety and Mgmt Team	(202) 366-4675	shay.burrows@dot.gov	T-18
Thomas K. Saad	Senior Structural Engineer	(708) 283-3521	thomas.saad@dot.gov	T-19
William M. Bergeson	Senior Tunnel Engineer	(202) 366-4847	william.bergeson@dot.gov	T-20

FULL SERVICE

Bridge Engineering Solutions



MODJESKI and MASTERS



Modjeski and Masters, an employee-owned company, is a nationwide leader in the design, inspection, and rehabilitation of all bridge types.

Pictured: New Portageville Bridge | Portageville, NY

PROUDLY SUPPORTING AASHTO

     | www.modjeski.com

Question the existing
Imagine the impossible
Create the enduring



Bayonne Bridge Navigational Clearance Project
Bayonne, New Jersey and Staten Island, New York

WSP's Role: Design (in joint venture)

Clients partner with WSP to mobilize communities from coast to coast, drawing on our expertise in the planning, design and management of transportation infrastructure.

Find out what we can do for you.

wsp

wsp.com/usa

Join our team!



 **AUTODESK**

BIM FOR INFRASTRUCTURE

Reimagining Infrastructure

- ▶ Reality Capture and Context Modeling
- ▶ Design Automation and Collaboration
- ▶ Virtual Design and Construction

Start your BIM journey

AUTODESK.COM/INFRASTRUCTURE

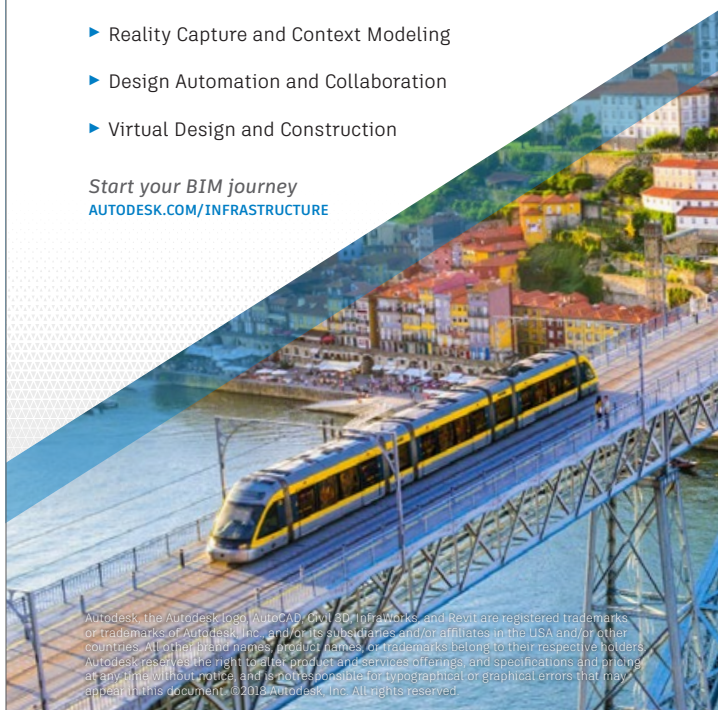

Autodesk, the Autodesk logo, AutoCAD, Revit, and InfraWorks are registered trademarks or trademarks of Autodesk, Inc., and/or its subsidiaries and/or affiliates in the USA and/or other countries. All other brand names, product names, or trademarks belong to their respective holders. Autodesk reserves the right to alter product offerings and specifications and pricing at any time without notice, and is not responsible for typographical or graphical errors that may appear in this document. ©2013 Autodesk, Inc. All rights reserved.

AASHTO *Regional Map*

Region IV

Alaska, Arizona, California, Colorado, Hawaii, Idaho, Montana, Nebraska, Nevada, New Mexico, North Dakota, Oklahoma, Oregon, South Dakota, Texas*, Utah, Washington, Wyoming



Region III

Illinois, Indiana, Iowa, Kansas, Kentucky*, Michigan, Minnesota, Missouri, Ohio, Wisconsin

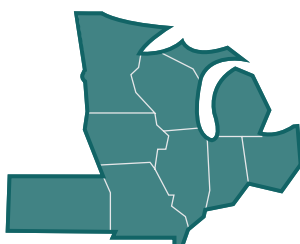

Region I

Connecticut, Delaware, Maine, Maryland, Massachusetts, New Hampshire, New Jersey, New York, Pennsylvania, Puerto Rico, Rhode Island, Vermont, District of Columbia



Region II

Alabama, Arkansas, Florida, Georgia, Kentucky*, Louisiana, Mississippi, North Carolina, South Carolina, Tennessee, Texas*, Virginia, West Virginia

* Both Kentucky (Regions II & III) and Texas (Regions III & IV) reside within two regions.

AASHTO *Technical Committee Rosters*

Executive Committee

Carmen E.L. Swanwick
Utah, Region 4, T-14, Chair

Scot Becker
Wisconsin, Region 3, Vice Chair, T-19

Joseph L. Hartmann
FHWA Liaison

Patricia Bush
AASHTO Liaison

Cheryl Hersh Simmons
Utah, Region 4, T-1

Carl Puzey
Illinois, Region 3, T-2

Richard A. Pratt
Alaska, Region 4, T-3

Jeffery Robert
Maryland, Region 1, T-5

Matthew Chynoweth
Michigan, Region 3, T-6

Timothy J. Keller
Ohio, Region 3, T-7

Zheng Zheng Fu
Louisiana, Region 2, T-8

James Nelson
Iowa, Region 3, T-9

Kevin L. Western
Texas, Region 4, T-10

Anne M Rearick
Indiana, Region 3, T-11

Jason N. Hastings
Delaware, Region 1, T-12

Sam Fallaha
Minnesota, Region 3, T-13

Thomas P. Macioce
Pennsylvania, Region 1, T-14, T-16

Tony M. Allen
Washington State, Region 4, T-15

Alexander K. Bardow
Massachusetts, Region 1, T-17

Matt M. Farrar
Idaho, Region 4, T-18

Louis J. Ruzzi
Pennsylvania, Region 1, T-20

Erin K. Grady
AASHTO

Ryan E. Holman
AASHTO

T-1

Cheryl Hersh Simmons
Utah, Region 4, Chair

Dolores Valls
California, Region 4, Vice Chair



Brenda Crudele
New York, Region 1

Artur D'Andrea
Louisiana, Region 2

Jeff A. Pouliotte
Florida, Region 2

Andrew Fitzgerald
Indiana Region 3

Rebecca Curtis
Michigan, Region 3

Bernie Carrasco
Texas, Region 4

James Harkness
*Maryland Transportation Authority,
Associate Member*

Vincent Chiarito
FHWA Liaison

Sheila Rimal Duwadi
FHWA Liaison

T-2

Carl Puzey
Illinois, Region 3, Chair

Leslie Daugherty
Alaska, Region 4, Vice Chair

Jason Arndt
Delaware, Region 1

Konjit Eskender
District of Columbia, Region 1

Ahmed Mongi
West Virginia, Region 2

Marvin Wolfe
Kentucky, Region 2

Rebecca Nix
Utah, Region 4

Mark J. Traynowicz
Nebraska, Region 4

Tuong Linh Nguyen Warren
FHWA Liaison

T-3

Richard A. Pratt
Alaska, Region 4, Chair

Dennis Heckman
Missouri, Region 3, Vice Chair

Alexander K. Bardow
Massachusetts, Region 1

Charles "Rick" Ellis
Arkansas, Region 2

Terry B. Koon
South Carolina, Region 2

Carl Puzey
Illinois, Region 3

Tony M. Allen
Washington State, Region 4

Stephanie Brandenberger
Montana, Region 4

Albert Nako
Oregon, Region 4

Thomas A. Ostrom
California, Region 4

Jia-Dzwan (Jerry) Shen
FHWA Liaison

T-4

Carmen E.L. Swanwick
Utah, Region 4, Chair

Ahmad Abu-Hawash
Iowa, Region 3, Vice Chair

Timothy Fields
Connecticut, Region 1

Kristin Higgins
Vermont, Region 1

Tim Colquett
Alabama, Region 2

Ted Kniazewycz
Tennessee, Region 2

Matthew Chynoweth
Michigan, Region 3

Bill C. Dreher
Wisconsin, Region 3

Kathy Crowell
New Mexico, Region 4

Mark A. Gaines
Washington State, Region 4

Romeo Garcia
FHWA Liaison

T-5

Jeffery Robert
Maryland, Region 1, Chair

Gudmund Setberg
*California, Region 4,
Vice Chair*

Michael H. Wight
Maine, Region 1

Bill DuVall
Georgia, Region 2

Sam Fallaha
Florida, Region 2

Arielle Ehrlich
Minnesota, Region 3

John Jones
Kansas, Region 3

Scot Becker
Wisconsin, Region 3

Jeff Booher
Wyoming, Region 4

Mark Ahlman
Nebraska, Region 4

Troy Martin
Nevada, Region 4

Elmer Marx
Alaska, Region 4

Lubin Gao
FHWA Liaison

T-6

Matthew Chynoweth
Michigan, Region 3, Chair

Wayne L. Frankhauser
Maine, Region 1, Vice Chair

Georgette Chahine
Rhode Island, Region 1

William Potter
Florida, Region 2

Andrew M. Zickler
Virginia, Region 2

Timothy J. Keller
Ohio, Region 3

Thomas A. Ostrom
California, Region 4

Tanarat Potisuk
Oregon, Region 4

Jamal I. Elkaissi
FHWA Liaison

T-7

Timothy J. Keller
Ohio, Region 3, Chair

Arielle Ehrlich
Minnesota, Region 3, Vice Chair

Alexander K. Bardow
Massachusetts, Region 1

Jim Lacroix
Vermont, Region 1

Jeffery Robert
Maryland, Region 1

Tim Colquett
Alabama, Region 2

Chris Guidry
Louisiana, Region 2

Andrew Zickler
Virginia, Region 2

Anne M. Rearick
Indiana, Region 3

Steve Johnson
South Dakota, Region 4

Waider Wong
FHWA Liaison

T-8

Zheng Zhen
"Jenny" Fu
Louisiana, Region 2, Chair

Prasad L. Nallapaneni
Virginia, Region 2, Vice Chair

Jesse Creel
Maryland, Region 1

Rebecca Curtis
Michigan, Region 3

Bijan Khaleghi
Washington State, Region 4

Jon Henrichsen
*Multnomah County Transportation
Division*

Brian Kozy
FHWA Liaison

T-9

James S. Nelson
Iowa, Region 3, Chair

Jeff A. Pouliotte
Florida, Region 2, Vice Chair

Wayne L. Frankhauser
Maine, Region 1

Richard Marchione
New York, Region 1

Randall Mullins
Alabama, Region 2

Kendal R. Walus
Virginia, Region 2

Graham Bettis
Texas, Region 4

Kathy Crowell
New Mexico, Region 4

Pe-Shen Yang
Arizona, Region 4

David Miller
*Louisiana, Cmte.
on Maintenance*

Raj Ailaney
FHWA Liaison

T-10

Kevin Western
Minnesota, Region 3, Chair

Matt M. Farrar
Idaho, Region 4, Vice Chair

Robert Landry
*New Hampshire,
Region 1*

Thomas P. Macioce
Pennsylvania, Region 1

Zheng Zhen
"Jenny" Fu
Louisiana, Region 2

Hongfen Li
South Carolina, Region 2

William Potter
Florida, Region 2

Bill C. Dreher
Wisconsin, Region 3

Mark E. Hoppe
Kansas, Region 3

James S. Nelson
Iowa, Region 3

Jamie F. Farris
Texas, Region 4

Fouad Jaber
Nebraska, Region 4

Bijan Khaleghi
Washington State, Region 4

Tanarat Potisuk
Oregon, Region 4

Gudmund Setberg
California, Region 4

Reggie Holt
FHWA Liaison

T-11

Anne M. Rearick
Indiana, Region 3, Chair

Thomas A. Ostrom
California, Region 4, Vice Chair

William Potter
Florida, Region 2

Kristin M. Higgins
Vermont, Region 1



Bart Asher
Kentucky, Region 2

Zheng Zhen
"Jenny" Fu
Louisiana, Region 2

Ted A. Kniazewycz
Tennessee, Region 2

William Potter
Florida, Region 2

William Oliva
Wisconsin, Region 3

Jon D. Ketterling
North Dakota, Region 4

Phillip W. Sauser
*U.S. Army Corps of Engineers,
Associate Member*

Benjamin A. Graybeal
FHWA Liaison

T-12

Sam Fallaha
Florida, Region 2, Chair

Jason N. Hastings
*Delaware, Region 1,
Vice Chair*

Georgette K. Chahine
Rhode Island, Region 1

Xiaohua "Hannah" Cheng
New Jersey, Region 1

John Jones
Kansas, Region 3

Stephanie Wagner
Indiana, Region 3

David Benton
Arizona, Region 4

James Fu
Hawaii, Region 4

Michael E. Menghini
Wyoming, Region 4

Jessen Mortensen
Nevada, Region 4

Derek J. Soden
FHWA Liaison

T-13

Jason N. Hastings
Delaware, Region 1, Chair

Kevin L. Western
Minnesota, Region 3

Ernest Holmberg
New York, Region 1

Marvin Wolfe
Kentucky, Region 2

Jeffrey E. Syar
Ohio, Region 3

Michael Collins
Colorado, Region 4

Steve Johnson
South Dakota, Region 4

Mark A. Gaines
Washington State, Region 4

Rebecca Nix
Utah, Region 4

Anwar Ahmad
FHWA Liaison

T-14

Thomas P. Macioce
Pennsylvania, Region 1, Chair

Richard Marchione
New York, Region 1, Vice Chair

Konjit Eskender
District of Columbia, Region 1

Sam Fallaha
Florida, Region 2

Brian Hanks
North Carolina, Region 2

John Jones
Kansas, Region 3

Carl Puzey
Illinois, Region 3

Matthew M. Farrar
Idaho, Region 4

Jamie F. Farris
Texas, Region 4

Ted Kniazewycz
Tennessee, Region 4

Shane Kulhman
New Mexico, Region 4

Elmer Marx
Alaska, Region 4

Michael E. Menghini
Wyoming, Region 4

Justin Ocel
FHWA Liaison

Dayi Wang
FHWA Liaison

T-15

Tony M. Allen
Washington State, Region 4, Chair

David L. Scott
*New Hampshire, Region 1,
Vice Chair*

Ernest Holmberg
New York, Region 1

Jim Lacroix
Vermont, Region 1

Tim Colquett
Alabama, Region 2

Steve Gaston
Georgia, Region 2

Scott Hidden
North Carolina, Region 2

Jeff Sizemore
South Carolina, Region 2

Alexander B.C. Dettloff
Ohio, Region 3

Jeff R. Booher
Wyoming, Region 4

David L. Eberhart
Arizona, Region 4

Jessica Martinez
Colorado, Region 4

Richard A. Pratt
Alaska, Region 4

Silas Nichols
FHWA Liaison

T-16

Thomas P. Macioce
Pennsylvania, Region 1, Chair

Alexander K. Bardow
Massachusetts, Region 1, Vice Chair

Tracy W. Brown
West Virginia, Region 2

Ed Lutgen
Minnesota, Region 3

William Oliva
Wisconsin, Region 3

Richard A. Pratt
Alaska, Region 4

John R. Kattell
*USDA Forest Service,
Associate Member*

Sheila Rimal Duwadi
FHWA Liaison

T-17

Alexander K. Bardow
Massachusetts, Region 1, Chair

Justin Walker
Mississippi, Region 2, Vice Chair

Xiaohua "Hannah" Cheng
New Jersey, Region 1

Randall Mullins
Alabama, Region 2

Ahmed Mongi
West Virginia, Region 2

Leslie Daugherty
Alaska, Region 4

Jamie F. Farris
Texas, Region 4

Steve J. Jacobi
Oklahoma, Region 4

Jamie F. Farris
Texas, Region 4

Phillip W. Sauser
*U.S. Army Corps of Engineers,
Associate Member*

Justin Ocel
FHWA Liaison

T-18

Matt M. Farrar
Idaho, Region 4, Chair

Eric Christie
Alabama, Region 2, Vice Chair

Jason Arndt
Delaware, Region 1

Richard Runyen
Pennsylvania, Region 1

Richard Marchione
New York, Region 1

Artur D'Andrea
Louisiana, Region 2

Gichuru Muchane
North Carolina, Region 2

Jeff A. Pouliotte
Florida, Region 2

Tim Armbrecht
Illinois, Region 3

Ed Lutgen
Minnesota, Region 3

William Oliva
Wisconsin, Region 3

Anne M. Rearick
Indiana, Region 3

Paul Cortez
Wyoming, Region 4

Amanda Jackson
Montana, Region 4

Dolores Maria Valls
California, Region 4

Jeff C. Vigil
New Mexico, Region 4

Shay Burrows
FHWA Liaison

T-19

Scot Becker
Wisconsin, Region 3, Chair

Tim Armbrecht
Illinois, Region 3, Vice Chair

Brenda Crudele
New York, Region 1

Jason N. Hastings
Delaware, Region 1

Eric Christie
Alabama, Region 2

Brian Hanks
North Carolina, Region 2

Scott Westerfield
Mississippi, Region 2

Marvin Wolfe
Kentucky, Region 2

Ahmad Abu-Hawash
Iowa, Region 3

Michael Collins
Colorado, Region 4

Cheryl Hersh Simmons
Utah, Region 4

Amanda Jackson
Montana, Region 4

Steve Jacobi
Oklahoma, Region 4

Shane Kulhman
New Mexico, Region 4

Thomas K. Saad
FHWA Liaison

T-20

Louis J. Ruzzi
Pennsylvania, Region 1, Chair

Prasad L. Nallapaneni
Virginia, Region 2, Vice Chair

Joe Rigney
Massachusetts, Region 1

Tracy W. Brown
West Virginia, Region 2

Girchuru Muchane
North Carolina, Region 2

William Varney
West Virginia, Region 2

Stephen Harelson
Colorado, Region 4



(T-20 Roster cont'd)

Bijan Khaleghi
Washington State, Region 4

Albert Nako
Oregon, Region 4

Dolores Valls
California, Region 4

James Harkness
*Maryland Transportation Authority,
Associate Member*

Timothy R. Holloway
*Chesapeake Bay Bridge and Tunnel
District*

William M. Bergeson
FHWA Liaison

Bentley
Advancing Infrastructure

Going Digital
Accelerate your pace of possible!

Take your Digital Assessment
www.bentley.com/GoingDigital

AASHTO

STAY UP TO DATE ON
AASHTO PUBLICATIONS NEWS

Join the AASHTO Publications Mailing List!

Visit the AASHTO Store online at
<https://store.transportation.org>, and click
Mailing List Subscribe in the page footer.

MONTHLY NEWSLETTER
NEW PUBLICATIONS ALERTS

PUBLICATIONS CATALOG
SPECIAL PROMOTIONS AND DISCOUNTS

STORE
AASHTO

Click here for more information about our Bridges & Structures publications.

BRIDGES & STRUCTURES

Featured Publications

- AASHTO Publications Catalog, 2019 Volume 1
- A Policy on Geometric Design of Highways and Streets, 7th Edition
- AASHTO LRFD Bridge Construction Specifications, 4th Edition
- AASHTO LRFD Bridge Design Specifications, 8th Edition
- Manual for Assessing Bridge Structural Adequacy, Second Edition, Single Volume
- Standard Specifications for Transportation Structures and Highway Buildings, 10th Edition



Need WIFI?

Connect to WIFI Network Name
"Renaissance_Conference" and enter password
"Bridges" (not case sensitive). Don't forget to
download the App at <https://crowd.cc/s/2ZCQ4>

Thank you to our sponsors!

Premier Sponsors



Capitol Sponsor



Platinum Sponsors



Gold Sponsors



Silver Sponsors



Bronze Sponsors



Copper Sponsors



Awards Luncheon





SAVE THE DATE

AASHTO Committee on Bridges and Structures Annual Meeting

Branson, MO • June 1-4, 2020

Branson Convention Center
www.bransoncc.com



Professional Development Hours Form

Check off the sessions that you attend, and keep this form for your records. AASHTO does not provide PDH certificates.

Sessions	C.E. Hours	C.E. Hours Completed
Monday, June 24, 2019, 8:00 a.m.–Noon Morning Technical Sessions <ul style="list-style-type: none"> T-2 Bearings and Expansion Devices T-5 Loads and Loads Distribution T-8 Movable Bridges T-9 Bridge Preservation T-16 Timber Structures 	 4 4 4 4 4	
Monday, June 24, 2019, 1:00 p.m.–5:00 p.m. Afternoon Technical Sessions <ul style="list-style-type: none"> T-1 Bridge Security and Hazards T-3 Seismic T-10 Concrete Design T-12 Structural Supports T-19 Software and Technology 	 4 4 4 4 4	
Tuesday, June 25, 2019, 8:00 a.m.–Noon Morning Technical Sessions <ul style="list-style-type: none"> T-6 Fiber Reinforced Polymer Composites T-13 Culverts T-15 Substructures and Retaining Walls T-17 Metals Fabrication T-18 Bridge Management, Evaluation, and Rehabilitation 	 4 4 4 4 4	
Tuesday, June 25, 2019, 1:00 p.m.–5:00 p.m. Afternoon Technical Sessions <ul style="list-style-type: none"> T-1 Bridge Security and Hazards T-4 Construction T-7 Guardrail and Bridge Rail T-11 Research T-14 Structural Steel Design T-20 Tunnels 	 4 4 4 4 4	
Wednesday, June 26, 2019, 8:00 a.m.–Noon State Bridge Engineers Meeting	4	
Wednesday, June 26, 2019, 1:00 p.m.–5:00 p.m. General Session	4	
Thursday, June 27, 2019—8:00 a.m.–Noon General Session	4	
Thursday, June 27, 2019—1:00 p.m.–5:00 p.m. General Session	4	

Signature of Attendee _____

Date _____

Total PDH Hours
Completed



Supporting our communities

We understand how critical designing new and rehabilitating and maintaining existing bridge infrastructure is to the health—and future—of your community. From idea to execution, we ensure that new and existing bridges are not only highly functional, but also fit the local setting and become an asset that supports a community for decades to come.



Design with community in mind
stantec.com/bridges